

4

3

2

1

CONFIDENTIAL AND PROPRIETARY TO KZCO, INC. UNAUTHORIZED USE, DISCLOSURE OF REPRODUCTION IS PROHIBITED

FOR MORE DETAILS AND INFORMATION, CONTACT: SALES@KZCO.COM

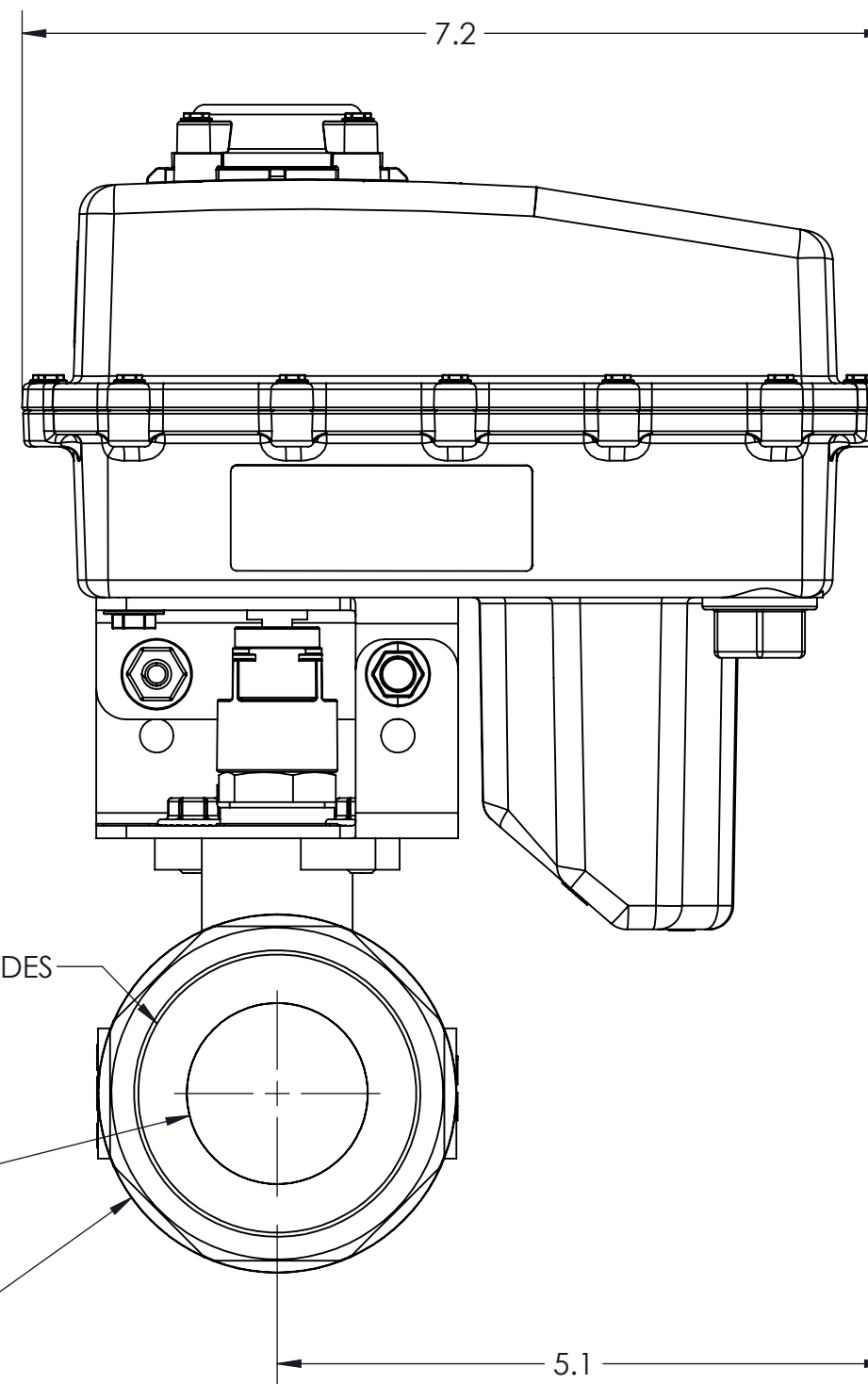
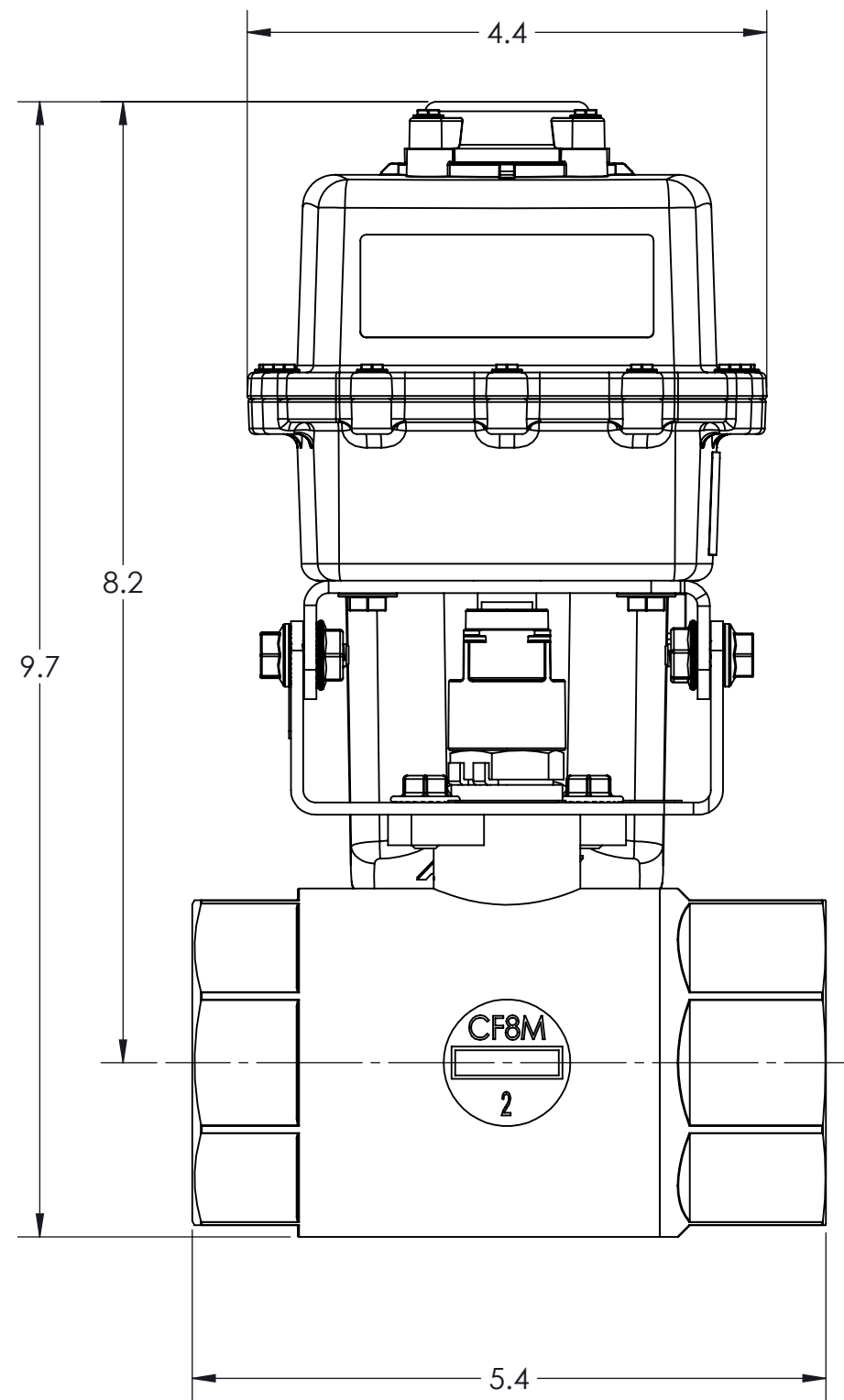

CONFORMS TO ASME STANDARDS Y14.5-2009

-STANDARD TOLERANCES- -ALL DIMENSIONS IN INCHES [mm]-	
.X±0.1	TOTAL RUNOUT: .005 FIM CORNER BREAK: .001 / .010 SURFACE FINISH: 125 µIN
.XX±0.001	
.XXX±0.005	
.X°±1°	
DENSITY: 0.059 LBM/CU IN MASS: 3.628 LBM SURF AREA: 753.855 SQ IN VOLUME: 61.391 CU IN	

DESIGNED BY: Brian Pham
DRAWN BY: Jason Moran
APPROVED:
SCALE: 2:3
SIZE: B
MATERIAL: Material <not specified>

<b>KZCO</b> inc.		23860 KZ PARKWAY GREENWOOD, NE 68366 USA PHONE: +1.402.944.2767 FAX: +1.402.944.2402	
TITLE: ACTUATED VALVE, EH22, 2" SS VENTED, 3S@12VDC, ON-OFF			
PART NO: 67122-10DW0-PF1		REV: 1	
DRAWING NO: SALES_67122-10DW0-PF1		SHEET: 1 OF 1	

4

3

2

1