

4

3

2

1

CONFIDENTIAL AND PROPRIETARY TO KZCO, INC. UNAUTHORIZED USE, DISCLOSURE OF REPRODUCTION IS PROHIBITED

FOR MORE DETAILS AND INFORMATION, CONTACT: SALES@KZCO.COM

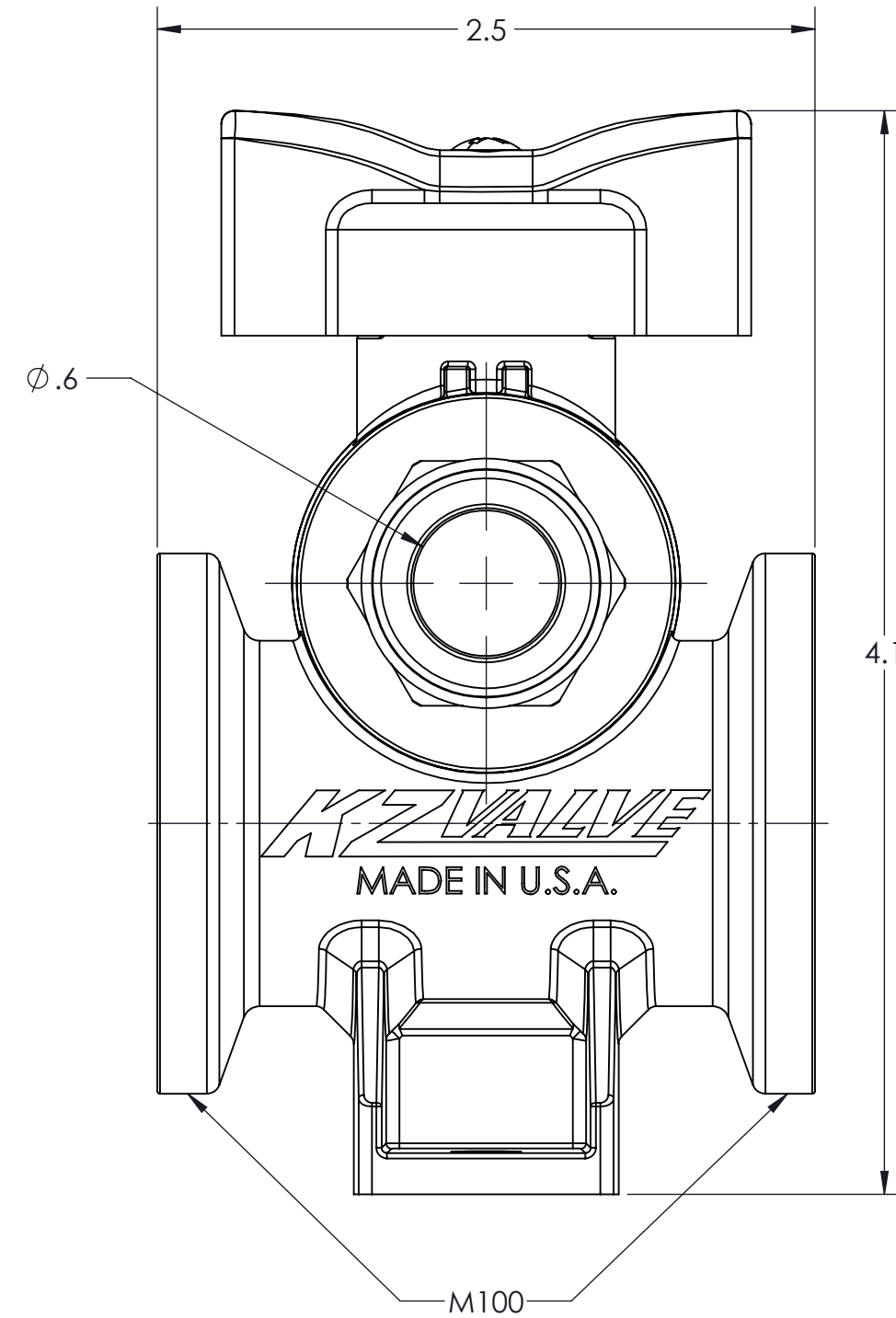
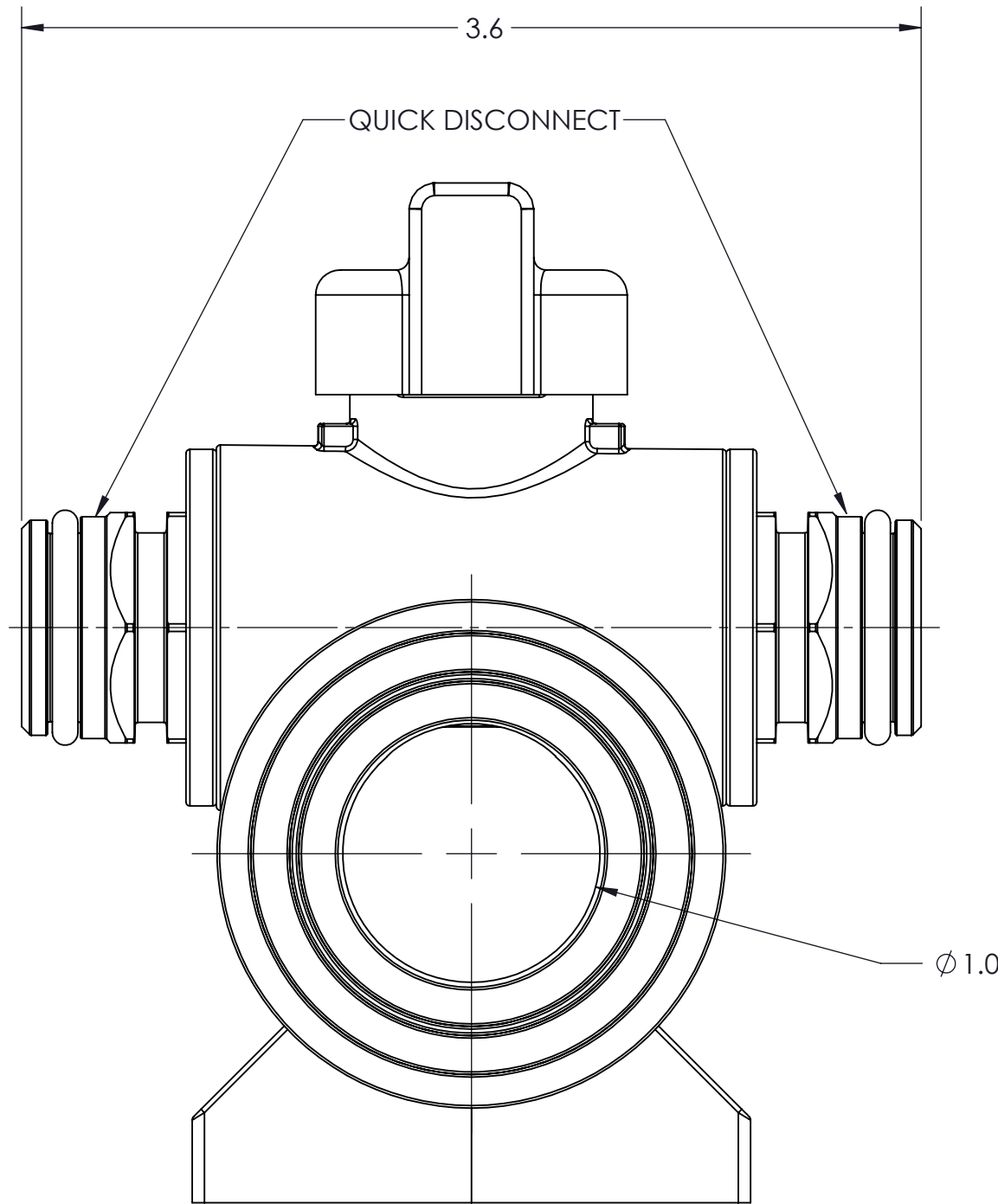

-STANDARD TOLERANCES- -ALL DIMENSIONS IN INCHES [mm]- .X±0.1 .XX±0.01 .XXX±0.005 .X°±1°	TOTAL RUNOUT: .005 FIM CORNER BREAK: .001/.010 SURFACE FINISH: 125 µIN 	DESIGNED BY: Brian Pham		23860 KZ PARKWAY GREENWOOD, NE 68366 USA PHONE: +1.402.944.2767 FAX: +1.402.944.2402
		DRAWN BY: Jason Moran		
DENSITY: 0.047 LBM/CU IN MASS: 0.325 LBM SURF AREA: 109.267 SQ IN VOLUME: 6.958 CU IN CONFORMS TO ASME STANDARDS Y14.5-2009		APPROVED:	TITLE: VALVE ASSY, TX2, 1/2" BL MNFD DIV, 1 SECTION, MANUAL	
		SCALE: 3:2		
		SIZE: B	PART NO: 21CA7M	REV: 1
		MATERIAL: Material <not specified>	DRAWING NO: SALES_21CA7M	SHEET: 1 OF 1

4

3

2

1

B

B

A

A