

4

3

2

1

CONFIDENTIAL AND PROPRIETARY TO KZCO, INC. UNAUTHORIZED USE, DISCLOSURE OF REPRODUCTION IS PROHIBITED

FOR MORE DETAILS AND INFORMATION, CONTACT: SALES@KZCO.COM

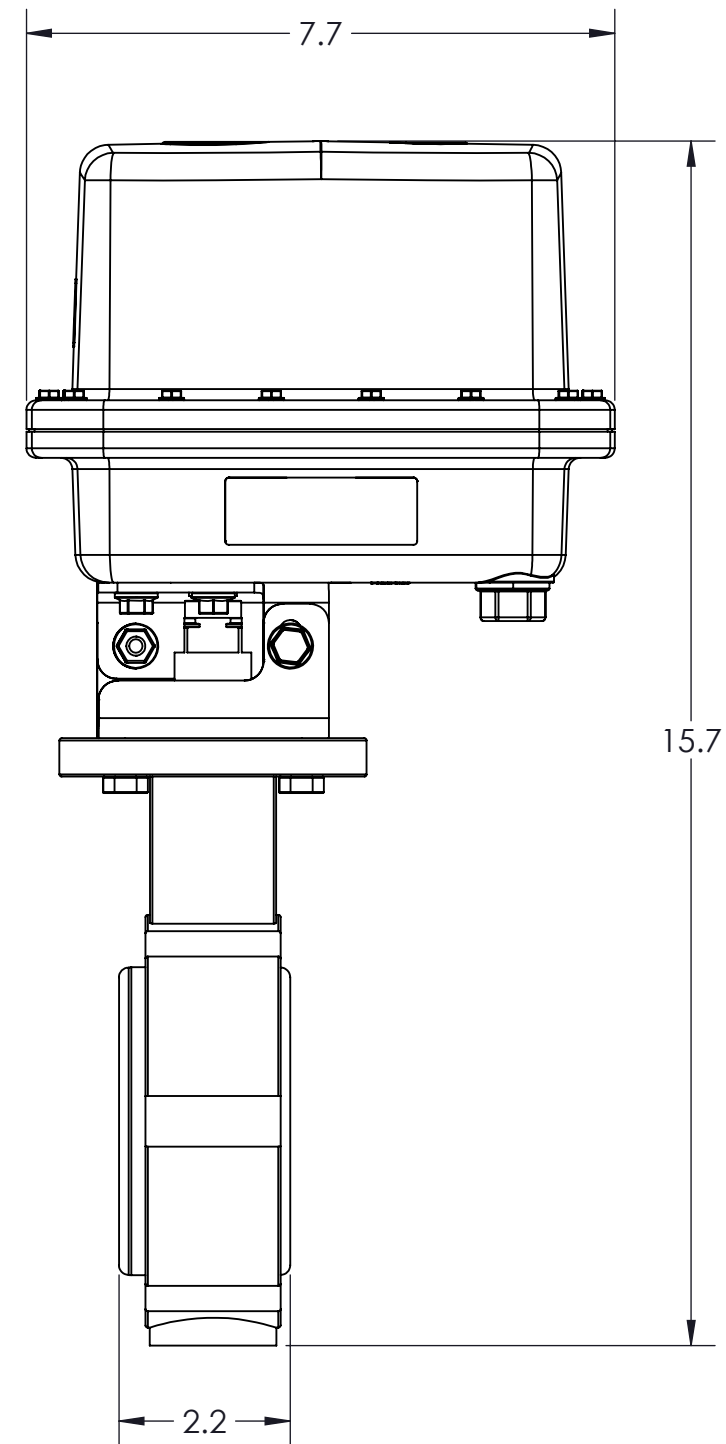
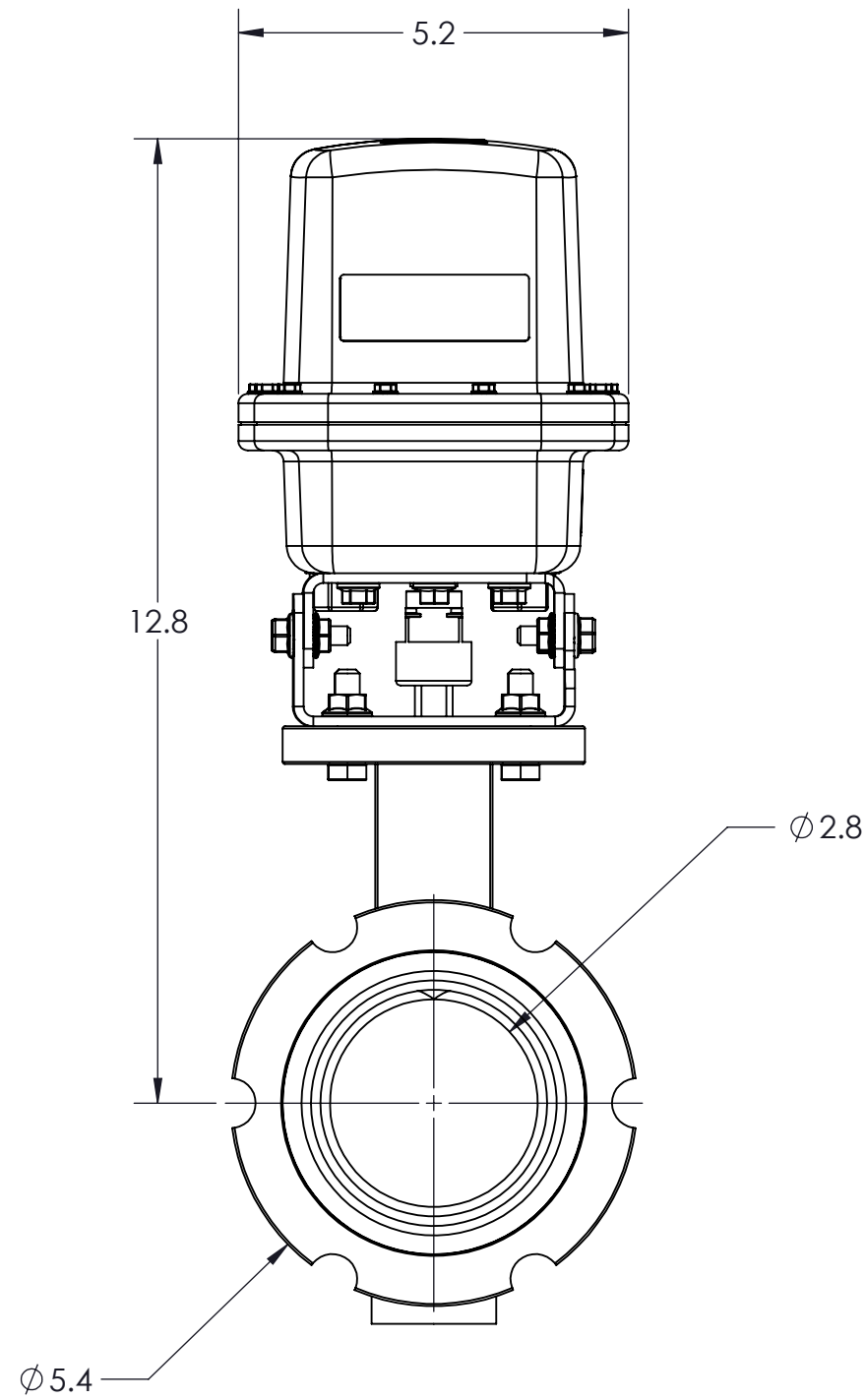

B

B

A

A

4

3

2

1

CONFORMS TO ASME STANDARDS Y14.5-2009

-STANDARD TOLERANCES- -ALL DIMENSIONS IN INCHES [mm]- .X±0.1 .XX±0.001 .XXX±0.005 .X°±1°		DESIGNED BY: Brian Pham DRAWN BY: Jason Moran APPROVED: SCALE: 2:5 SIZE: B MATERIAL: Material <not specified>	<p>23860 KZ PARKWAY GREENWOOD, NE 68366 USA PHONE: +1.402.944.2767 FAX: +1.402.944.2402</p>	TITLE: ACTUATED VALVE, EH5, 59K, SS BFLY, EPDM, 3S@12VDC, ON-OFF, DR4	
DENSITY: 3859.926 LBM/CU IN MASS: 391.625.973 LBM SURF AREA: 889.118 SQ IN VOLUME: 101.459 CU IN		PART NO: 59K35-10D50-DB1 DRAWING NO: SALES_59K35-10D50-DB1		REV: 1 SHEET: 1 OF 2	