

4

3

2

1

CONFIDENTIAL AND PROPRIETARY TO KZCO, INC. UNAUTHORIZED USE, DISCLOSURE OF REPRODUCTION IS PROHIBITED

FOR MORE DETAILS AND INFORMATION, CONTACT: SALES@KZCO.COM

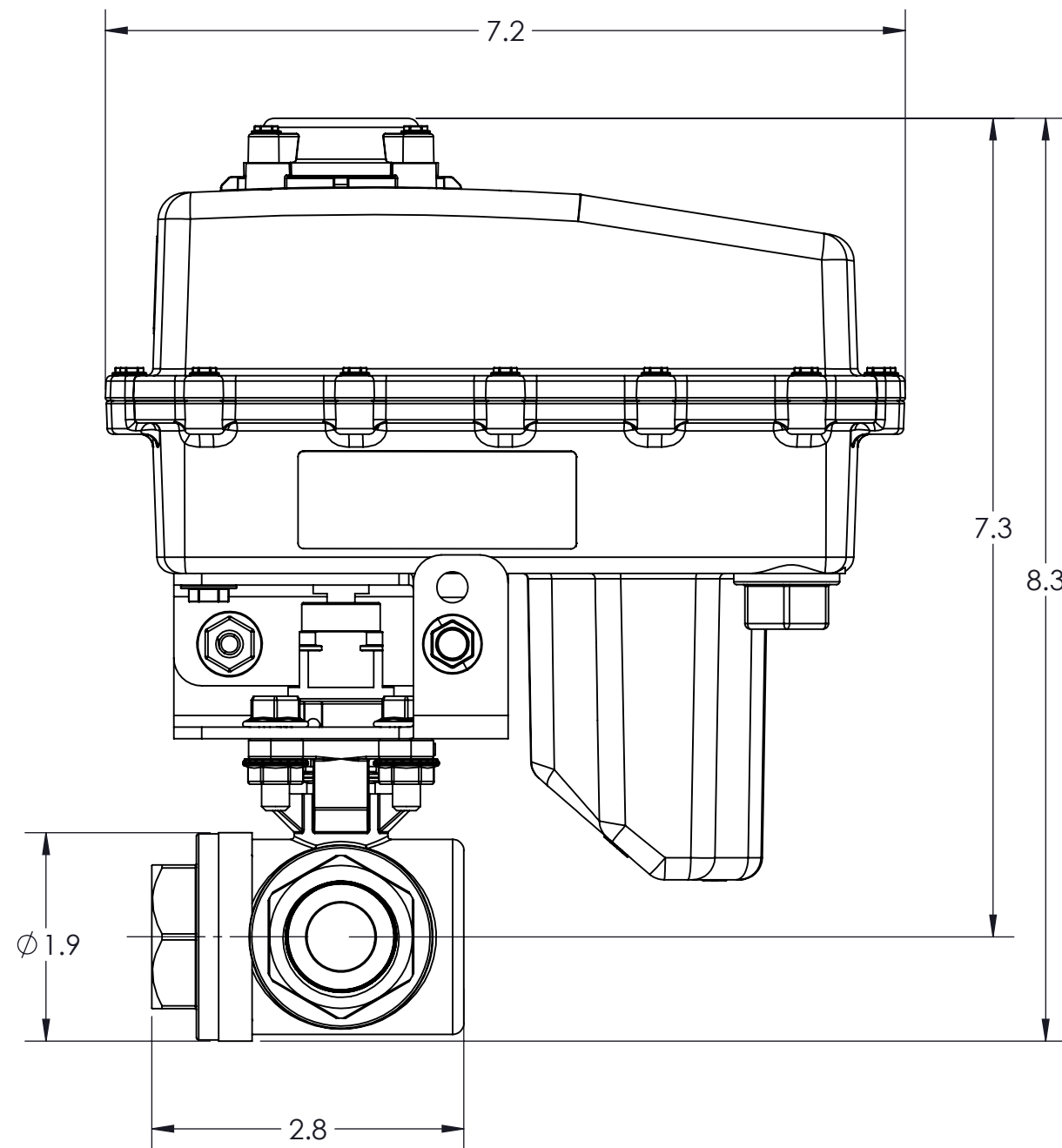
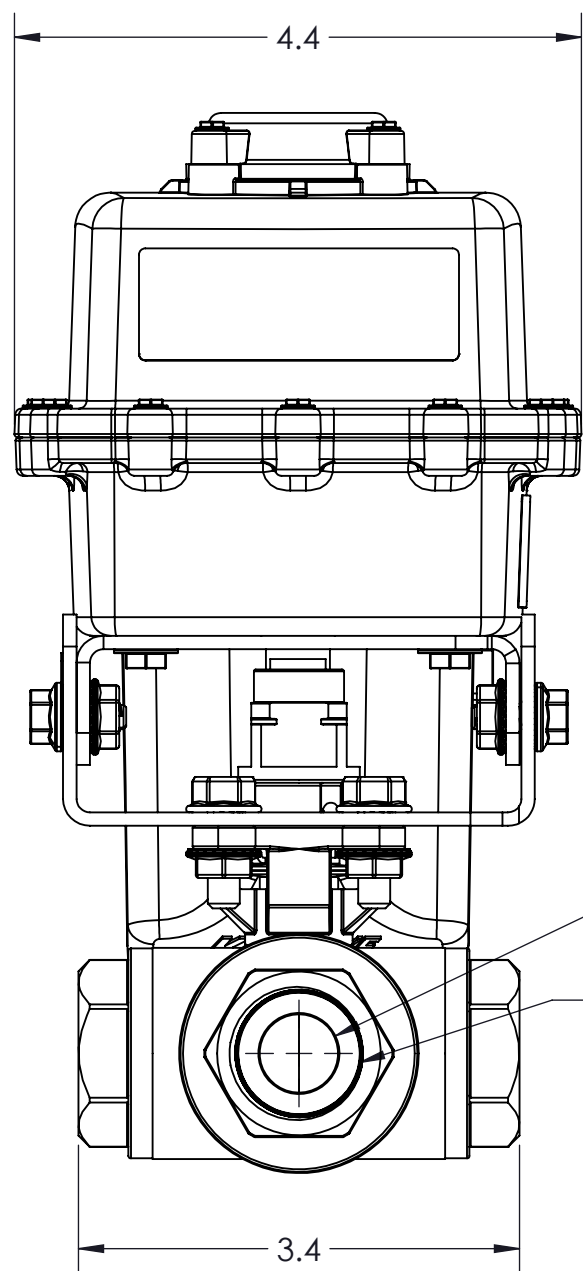

Ø.6  
3/4" NPT  
PLCS

CONFORMS TO ASME  
STANDARDS Y14.5-2009

-STANDARD TOLERANCES-  
-ALL DIMENSIONS IN INCHES [mm]-

.X±0.1	TOTAL RUNOUT: .005 FIM CORNER BREAK: .001/.010 SURFACE FINISH: 125 µIN 
.XX±0.01	
.XXX±0.005	
.XX°±1°	

DENSITY: 0.113 LBM/CU IN  
 MASS: 5.673 LBM  
 SURF AREA: 696.012 SQ IN  
 VOLUME: 50.367 CU IN

DESIGNED BY: Brian Pham  
 DRAWN BY: Aaron Goodwin  
 APPROVED:  
 SCALE: 2:3  
 SIZE: B  
 MATERIAL: AS NOTED



23860 KZ PARKWAY  
 GREENWOOD, NE 68366 USA  
 PHONE: +1.402.944.2767  
 FAX: +1.402.944.2402

TITLE: ACTUATED VALVE, EH22, 3/4", SS, 3-WAY, OFFSET  
 MTG, ON/OFF, 1.5 SEC @ 12VDC, 3ST WP3T

PART NO: 73E22-10DY0-P31

REV: 1

DRAWING NO: SALES\_73E22-10DY0-P31

SHEET: 1 OF 1

4

3

2

1

B

B

A

A