

4

3

2

1

CONFIDENTIAL AND PROPRIETARY TO KZCO, INC. UNAUTHORIZED USE, DISCLOSURE OF REPRODUCTION IS PROHIBITED

FOR MORE DETAILS AND INFORMATION, CONTACT: SALES@KZCO.COM

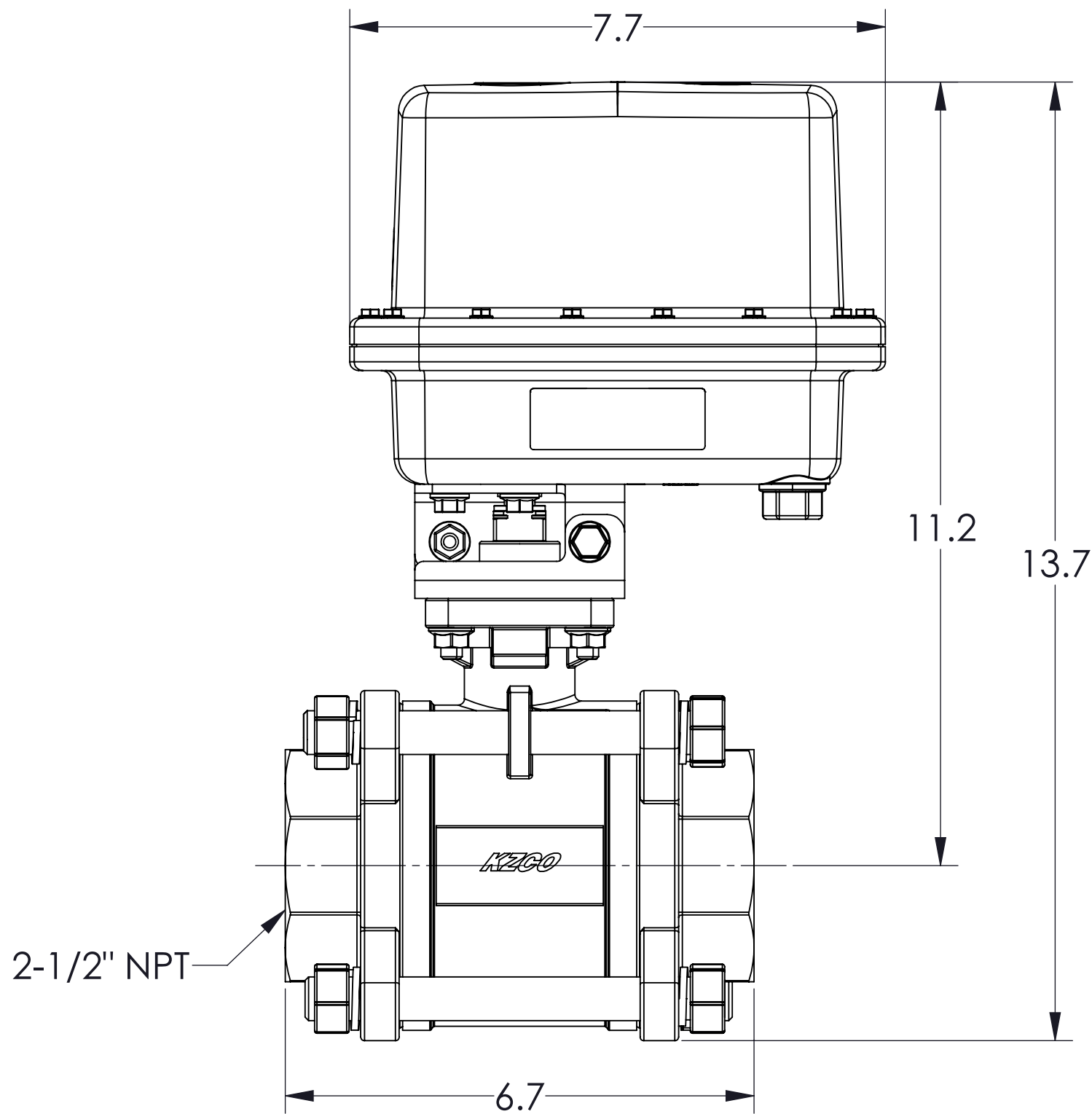
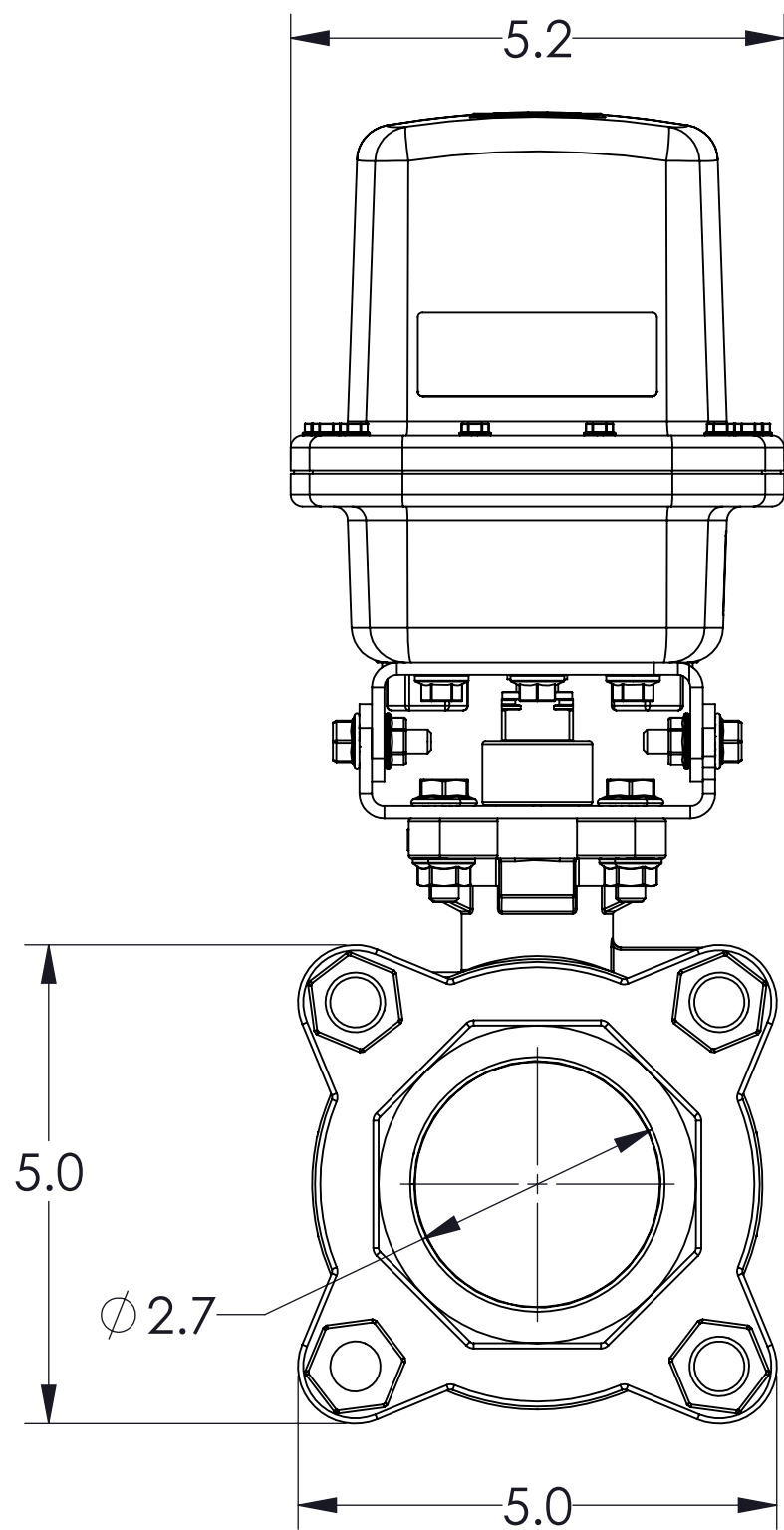

-STANDARD TOLERANCES- -ALL DIMENSIONS IN INCHES [mm]-	
.X±0.1	TOTAL RUNOUT: .005 FIM CORNER BREAK: .001/.010 SURFACE FINISH: 125 µIN
.XX±0.001	
.XXX±0.005	
.X°±1°	
DENSITY: 2975.621 LBM/CU IN MASS: 391.661.084 LBM SURF AREA: 1181.938 SQ IN VOLUME: 131.623 CU IN	

DESIGNED BY: Brian Pham
DRAWN BY: Aaron Goodwin
APPROVED:
SCALE: 1:2
SIZE: B
MATERIAL: AS NOTED

		23860 KZ PARKWAY GREENWOOD, NE 68366 USA PHONE: +1.402.944.2767 FAX: +1.402.944.2402	
		TITLE: ACTUATED VALVE, EH5, 2-1/2", SS 3-PC, 2-WAY, INLINE, ON/OFF, 3S@12VDC	
PART NO: 89J35-10D50-DB1	REV: 1		
DRAWING NO: SALES_89J35-10D50-DB1	SHEET: 1 OF 1		

CONFORMS TO ASME STANDARDS Y14.5-2009

4

3

2

1