

4

3

2

1

CONFIDENTIAL AND PROPRIETARY TO KZCO, INC. UNAUTHORIZED USE, DISCLOSURE OF REPRODUCTION IS PROHIBITED

FOR MORE DETAILS AND INFORMATION, CONTACT: SALES@KZCO.COM

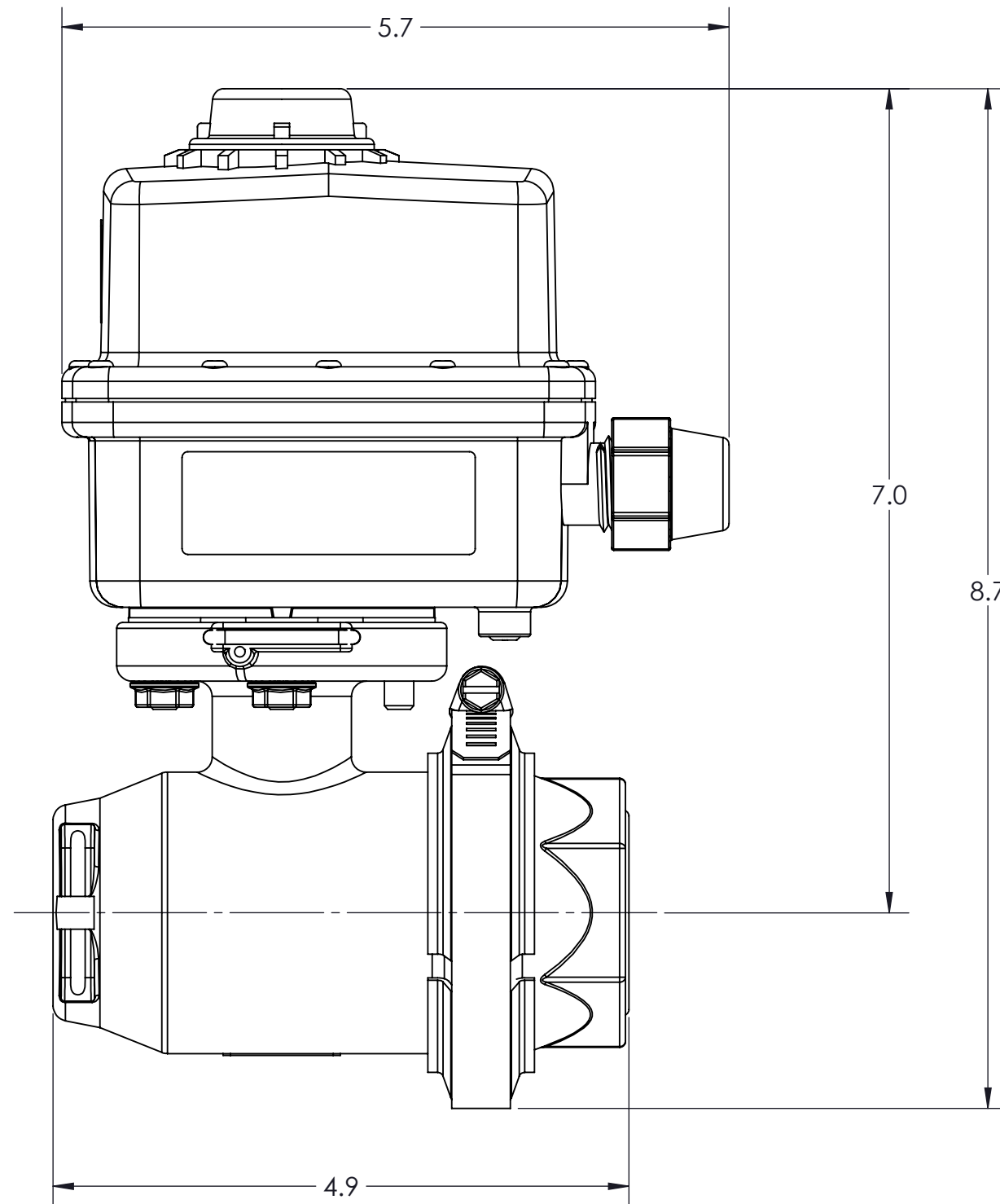
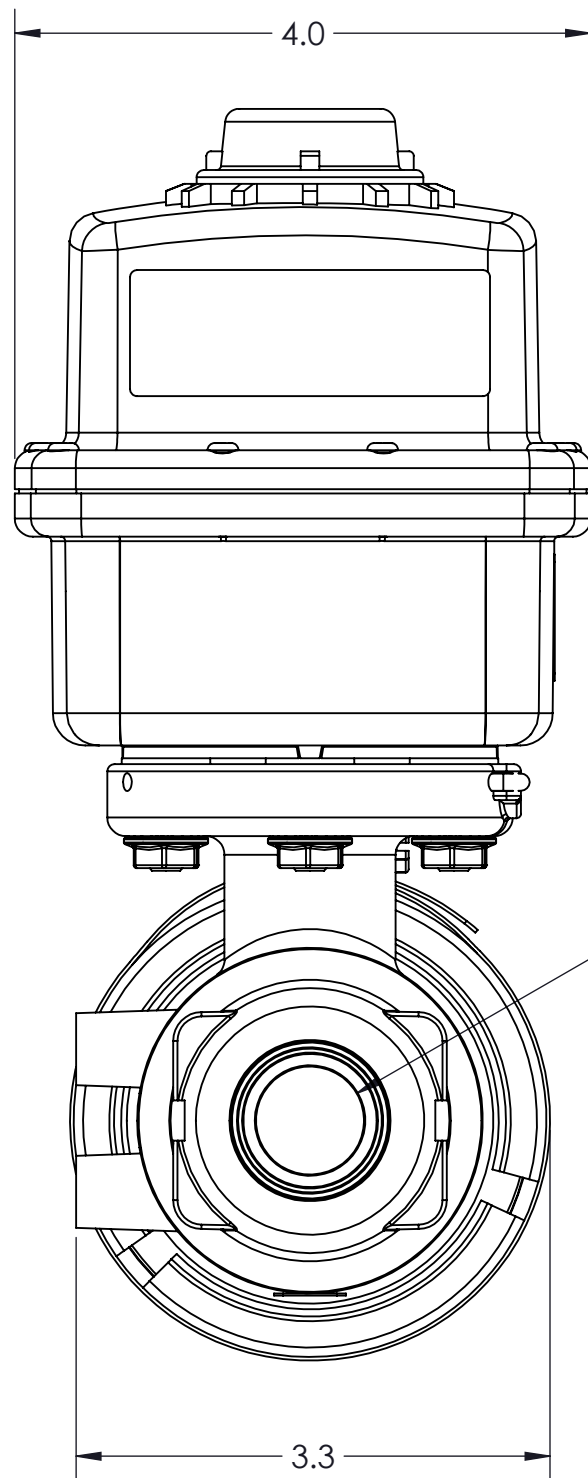

CONFORMS TO ASME STANDARDS Y14.5-2009

-STANDARD TOLERANCES-
-ALL DIMENSIONS IN INCHES [mm]-

.X±0.1
.XX±0.01
.XXX±0.005
.XX°±1°

TOTAL RUNOUT: .005 FIM
CORNER BREAK: .001/.010
SURFACE FINISH: 125 µIN

DENSITY: 0.072 LBM/CU IN
MASS: 3.365 LBM
SURF AREA: 585.293 SQ IN
VOLUME: 46.549 CU IN

DESIGNED BY: Lindsey Niemann
DRAWN BY: Jason Moran
APPROVED:
SCALE: 3:4
SIZE: B
MATERIAL: Material <not specified>



23860 KZ PARKWAY
GREENWOOD, NE 68366 USA
PHONE: +1.402.944.2767
FAX: +1.402.944.2402

TITLE: ACTUATED VALVE, EH3, 3/4", POLY 2-WAY FNPT, ON/OFF, 0.8 SEC @ 12VDC, 3ST WP3T

PART NO: F2E33-10D20-P01

REV: 1

DRAWING NO: SALES_F2E33-10D20-P01

SHEET: 1 OF 2

4

3

2

1

B

B

A

A