

4

3

2

1

CONFIDENTIAL AND PROPRIETARY TO KZCO, INC. UNAUTHORIZED USE, DISCLOSURE OF REPRODUCTION IS PROHIBITED

FOR MORE DETAILS AND INFORMATION, CONTACT: SALES@KZCO.COM

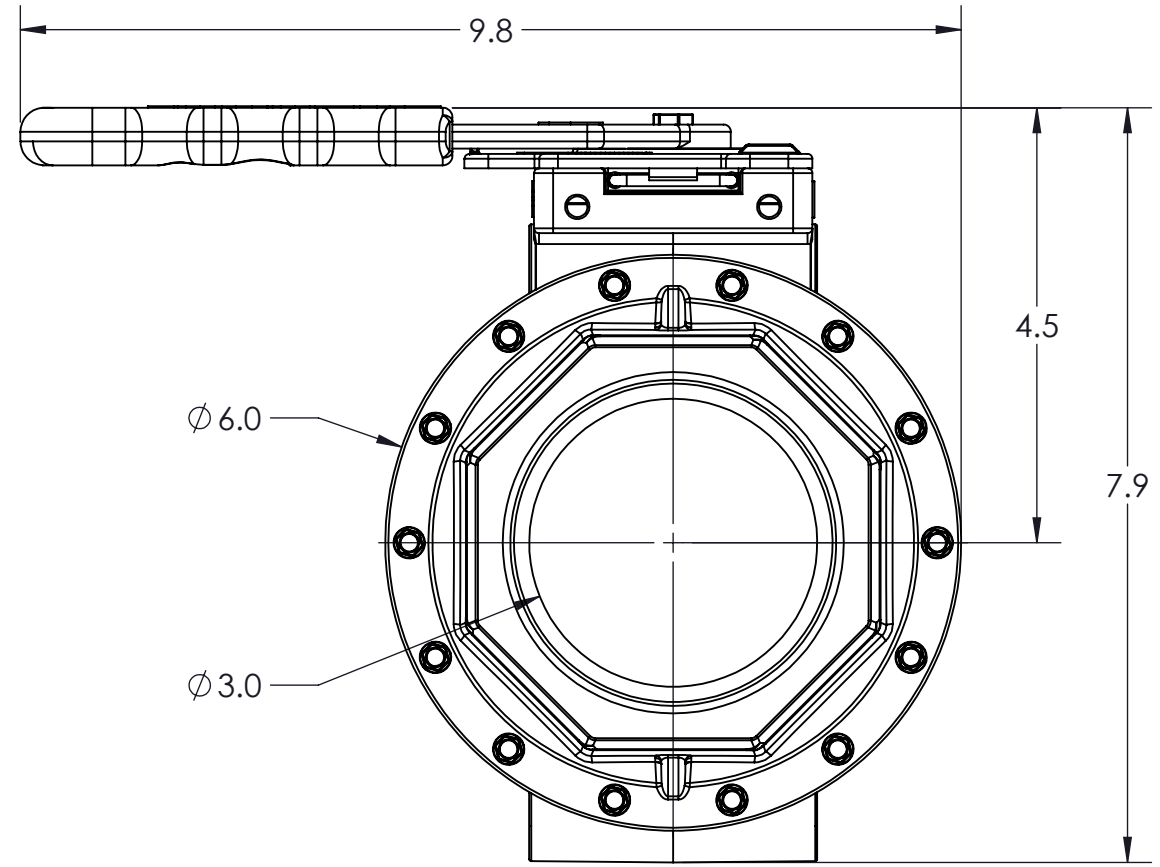
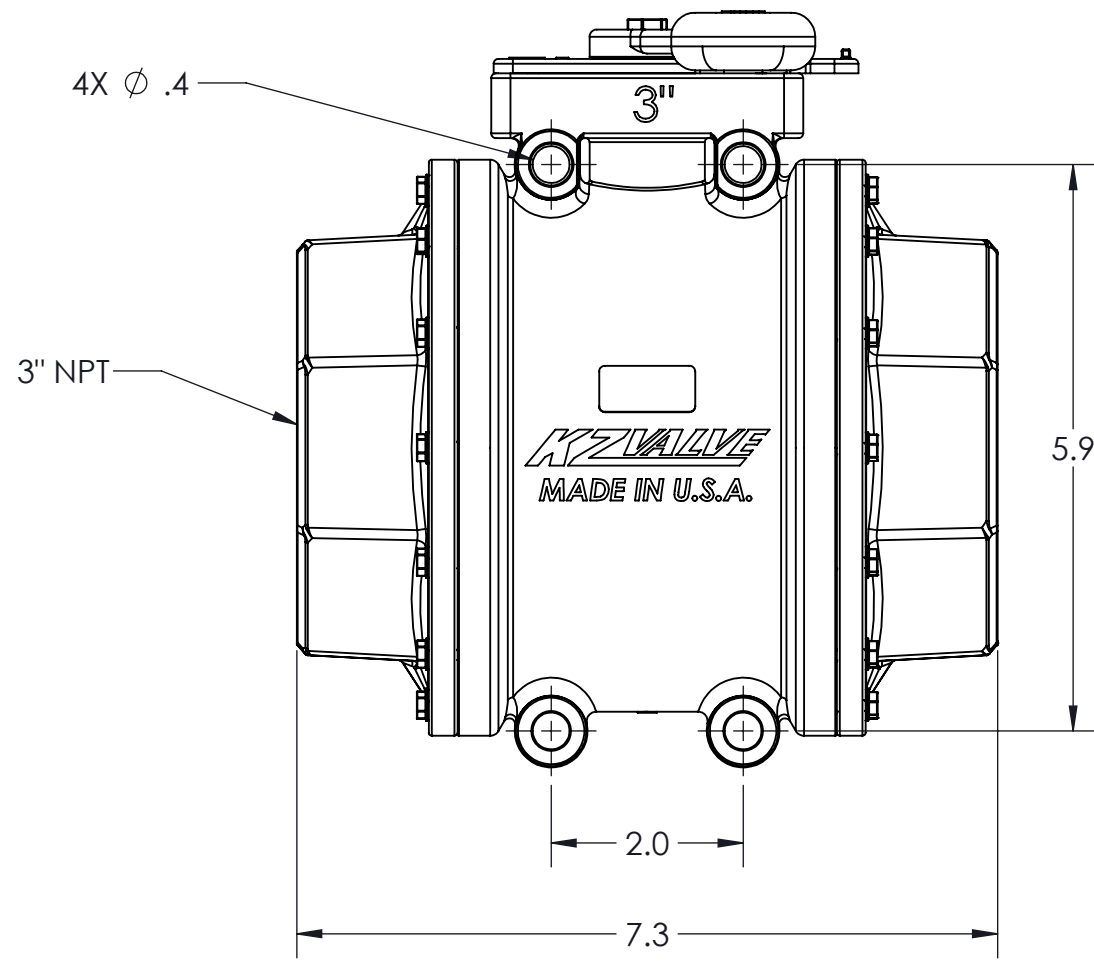

CONFORMS TO ASME STANDARDS Y14.5-2009

-STANDARD TOLERANCES- -ALL DIMENSIONS IN INCHES [mm]- .X±0.1 .XX±0.01 .XXX±0.005 .XX°±1°	TOTAL RUNOUT: .005 FIM CORNER BREAK: .001 / .010 SURFACE FINISH: 125 µIN 	DESIGNED BY: Larry Erdkamp		23860 KZ PARKWAY GREENWOOD, NE 68366 USA PHONE: +1.402.944.2767 FAX: +1.402.944.2402
		DRAWN BY: Jason Moran		
DENSITY: 0.045 LBM/CU IN MASS: 4.587 LBM SURF AREA: 695.205 SQ IN VOLUME: 102.305 CU IN		APPROVED:	PART NO: FM2KM0	REV: 1
		SCALE: 1:2	DRAWING NO: SALES_FM2KM0	SHEET: 1 OF 2
		SIZE: B		
		MATERIAL: Material <not specified>		

4

3

2

1