

CONFIDENTIAL AND PROPRIETARY TO KZVALVE, LLC. UNAUTHORIZED USE, DISCLOSURE OR REPRODUCTION IS PROHIBITED

CUSTOMER REVISIONS			
REV	ECN	CHANGE	MODIFIED BY
1	22-0019	INITIAL RELEASE	BENJAMIN KLINKEBIEL
2	22-0019	UPDATED INGRESS PROTECTION RATING	BENJAMIN KLINKEBIEL

PART NUMBER: LOEFS-D01
CUSTOMER: KZVALVE

DESIGN NOTES:

- KZVALVE SERIES: EH6
- ACTUATION TIME @ 90 DEGREES: 0.5 SEC
- AMBIENT OPERATING TEMP: -40°F TO 185°F (-40°C to 85°C)
- AMBIENT STORAGE TEMP: -67°F TO 221°F (-55°C to 105°C)
- ENCLOSURE RATING: IP69K PER ISO 20653, NEMA 6P & 7D PER NEMA 250
- UP TO 90 DEG OF TOTAL TRAVEL - ROTATION TO OPEN STATE IS CLOCKWISE WHEN VIEWED FROM THE BOTTOM SIDE, COUNTER-CLOCKWISE WHEN VIEWED FROM THE TOP SIDE
- ELECTRICAL
 - OPERATING INPUT VOLTAGE: 9VDC TO 32VDC
 - CURRENT DRAW
 - NORMAL OPERATION: 1.0 AMP@12VDC
 - CONTINUOUS (RUNNING STATE): 40 mA
 - STALL (LOCKED ROTOR): 3 AMPS@12VDC
 - ELECTRICAL CONNECTOR: DEUTSCH 4-PIN RECEPTACLE
 - ELECTRICAL PINOUT:
 - GND POWER 12/24VDC
 - CAN LOW
 - CAN HIGH
 - (+) POWER 12/24VDC

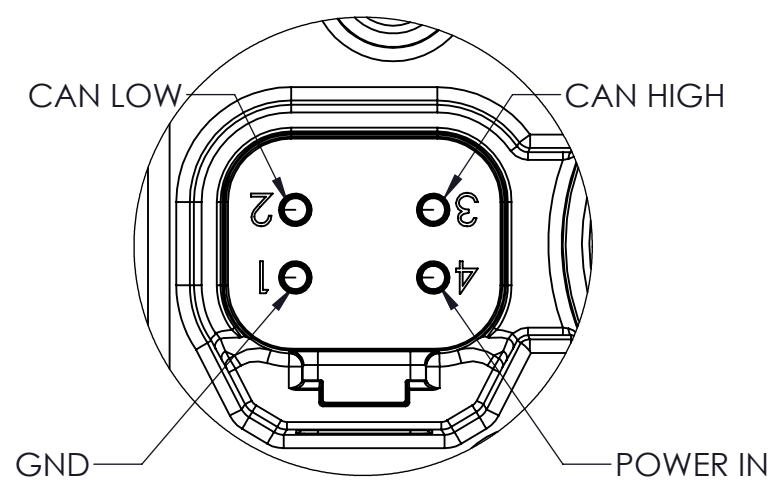
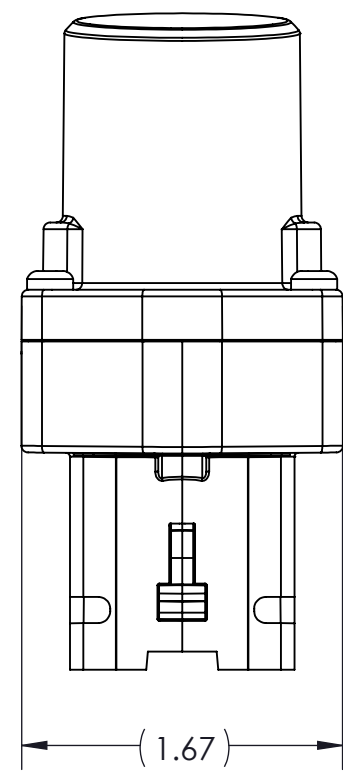
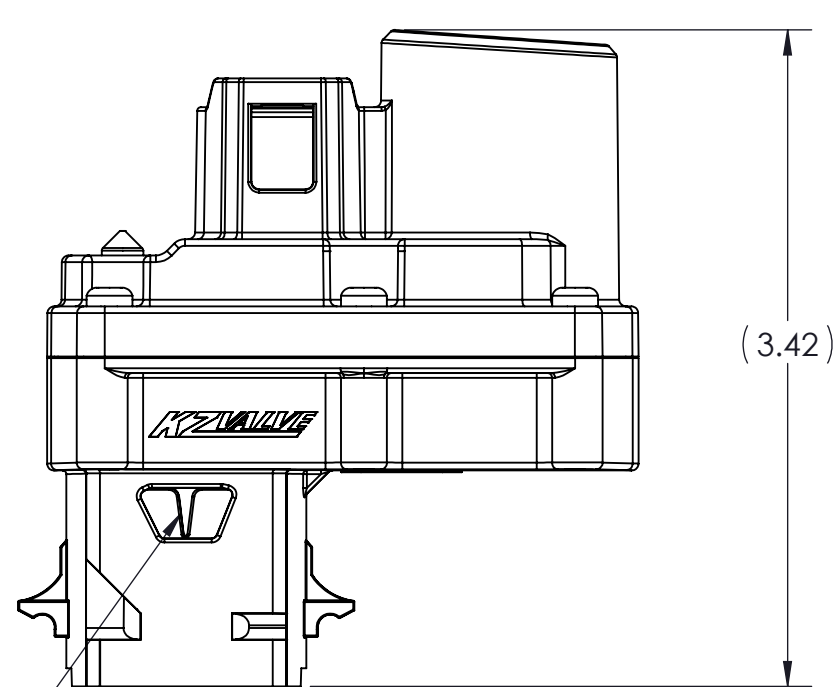
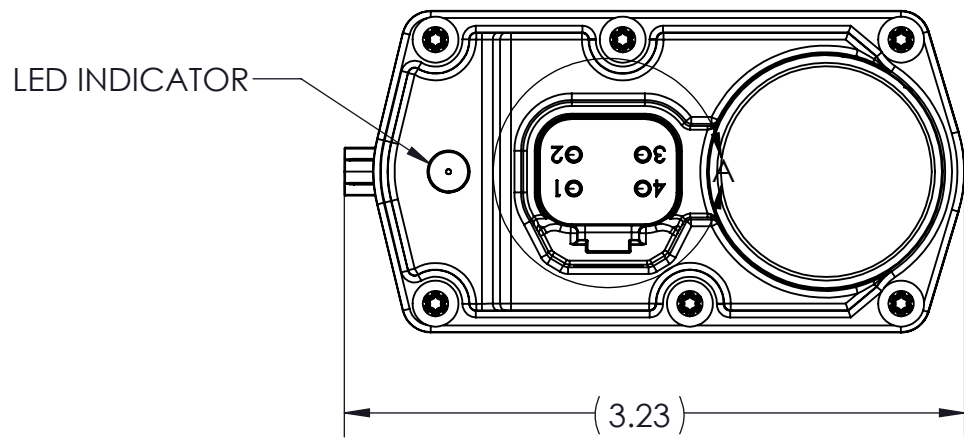

DETAIL A
SCALE 2 : 1

MECHANICAL FLAG INDICATOR
SHOWN IN CLOSED POSITION

OUTPUT SHAFT SHOWN IN
CLOSED POSITION

LED INDICATOR STATES			
INDICATOR	RATE	COLOR	STATUS
SOLID	-	GREEN	AT OPEN POSITION
SOLID	-	RED	AT CLOSED POSITION
BLINKING	2.8 Hz	RED	FAULT

CONFORMS TO ASME
STANDARDS Y14.5-2009

DENSITY: 0.036 LBM/CU IN
MASS: 0.185 LBM
SURF AREA: 128.308 SQ IN
VOLUME: 5.152 CU IN

DESIGNED BY: Benjamin Klinkebiel
DRAWN BY: Benjamin Klinkebiel
APPROVED:
SCALE: 1:1
SIZE: B
MATERIAL: AS NOTED

KZVALVE
23860 K2 PARKWAY
GREENWOOD, NE 68366 USA
PHONE: +1.402.944.2767
FAX: +1.402.944.2402

TITLE: ACTUATOR, EH6, CAN, 0.5S@12/24VDC, DR4

PART NO: LOEFS-D01
DRAWING NO: LOEFS-D01

REV: 2
SHEET: 3 OF 3