

4

3

2

1

CONFIDENTIAL AND PROPRIETARY TO KZCO, INC. UNAUTHORIZED USE, DISCLOSURE OF REPRODUCTION IS PROHIBITED

FOR MORE DETAILS AND INFORMATION, CONTACT: SALES@KZCO.COM

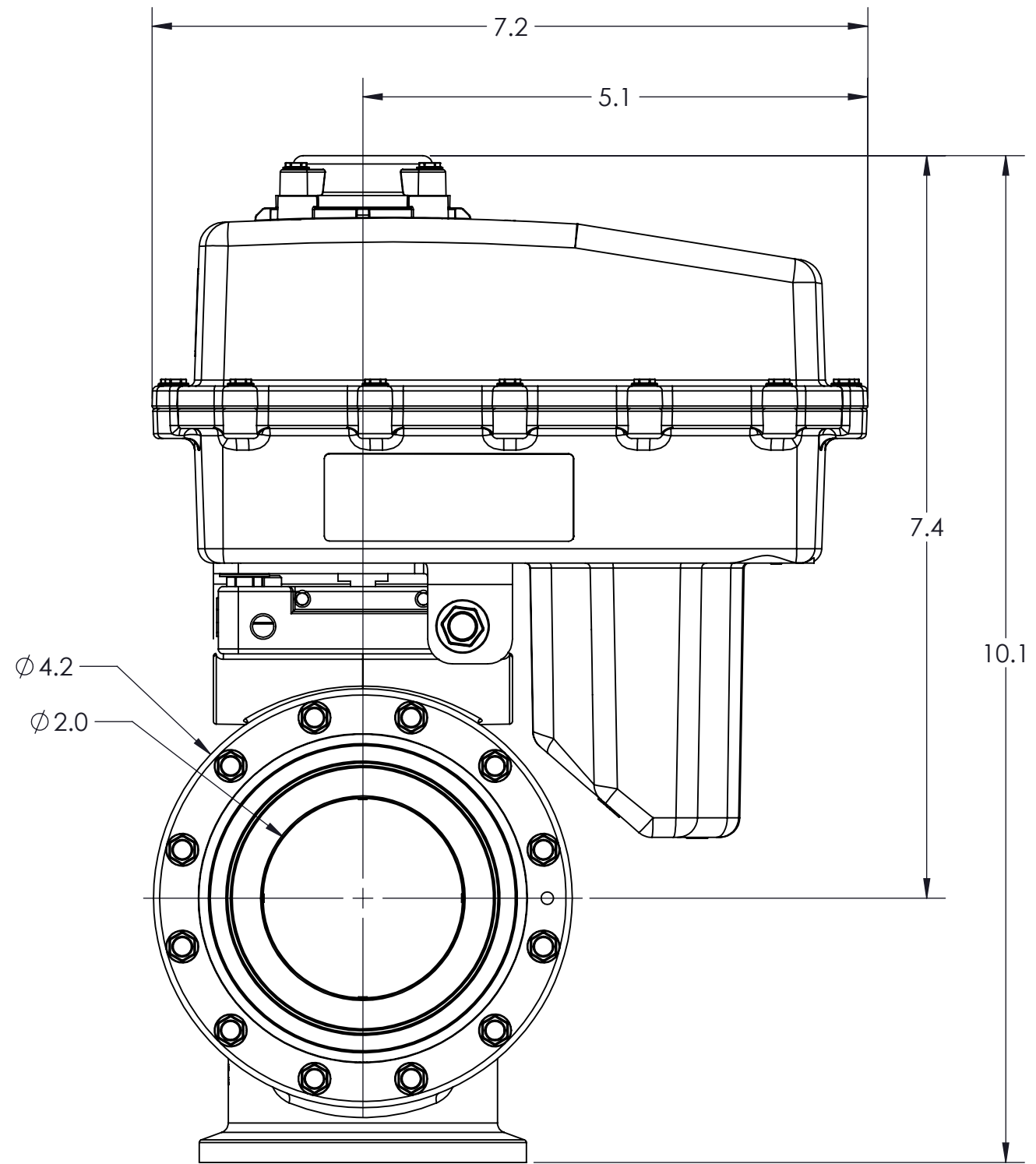
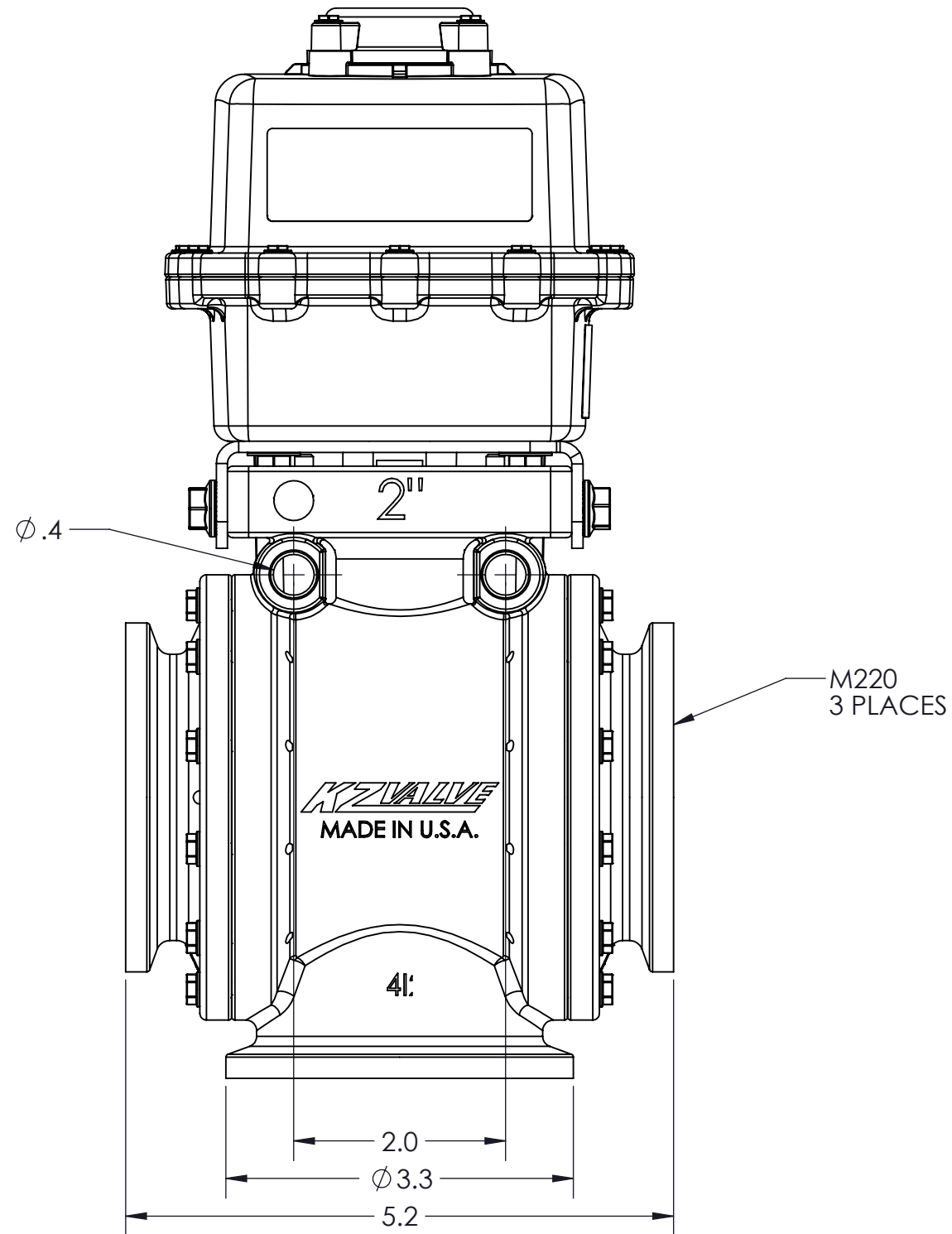

-STANDARD TOLERANCES- -ALL DIMENSIONS IN INCHES [mm]- .X±0.1 .XX±0.01 .XXX±0.005 .X°±1°		DESIGNED BY: Jason Moran DRAWN BY: Jason Moran APPROVED: SCALE: 2:3 SIZE: B MATERIAL: Material <not specified>
TOTAL RUNOUT: .005 FIM CORNER BREAK: .001/.010 SURFACE FINISH: 125 µIN 		TITLE: ACTUATED VALVE, EH22, 2" BL 3-WAY SELECTOR, 6S@12VDC, 180DEG ROT PART NO: M4I22-10DW0-PFV DRAWING NO: SALES_M4I22-10DW0-PFV
DENSITY: 0.048 LBM/CU IN MASS: 3.988 LBM SURF AREA: 910.368 SQ IN VOLUME: 82.821 CU IN		23860 KZ PARKWAY GREENWOOD, NE 68366 USA PHONE: +1.402.944.2767 FAX: +1.402.944.2402 REV: 1 SHEET: 1 OF 2

CONFORMS TO ASME STANDARDS Y14.5-2009

4

3

2

1

B

B

A

A