

DESIGN NOTES:

1. PART NUMBER: NMZB28-1CEBS-R01
2. KZVALVE ACTUATOR SERIES: EH8
3. ACTUATION TIME: 0.2S @ 12 VDC
4. AMBIENT OPERATING TEMP: -40°F TO 185°F (-40°C TO 85°C)
5. AMBIENT STORAGE TEMP: -67°F TO 221°F (-55°C TO 105°C)
6. ENCLOSURE RATING: IP68 PER ISO 20653, NEMA 6P/7D PER NEMA 250
7. UP TO 90 DEG OF TOTAL TRAVEL - ROTATION TO OPEN STATE IS CLOCKWISE WHEN VIEWED FROM THE BOTTOM SIDE
8. ELECTRICAL

1. OPERATING INPUT VOLTAGE: 9-32 VDC

2. CURRENT DRAW

1. NORMAL OPERATION: 0.4 AMPS @ 12 VDC

2. CONTINUOUS (RUNNING STATE): 0.04 AMPS

3. STALL (LOCKED ROTOR): 1.8 AMPS @ 12 VDC
3. CONNECTION: M12 CONNECTION

1. PIN MATERIAL: GOLD-PLATED BRASS
4. PINOUT

1. PIN 1: POWER IN (+)

2. PIN 2: (+) SIG TO OPEN

3. PIN 3: POWER IN (-)

4. PIN 4: (+) FEEDBACK AT CLOSED

9. VALVE

5. WETTED MATERIALS: FKM, CG REINFORCED PTFE, NYLON, 316SS

6. MAX PRESSURE DIFFERENTIAL: 150 PSI @ 70°F

7. MAX BODY PRESSURE: 300 PSI @ 70°F

8. FLOW RATE: 1.1 GPM @ 1 PSI PRESSURE DIFFERENTIAL

9. CONNECTIONS: 2X 1/4" MNPT CONNECTIONS

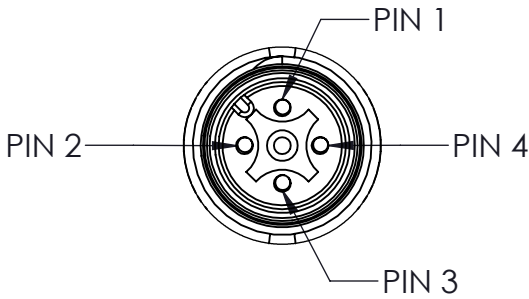

DETAIL A  
SCALE 2 : 1

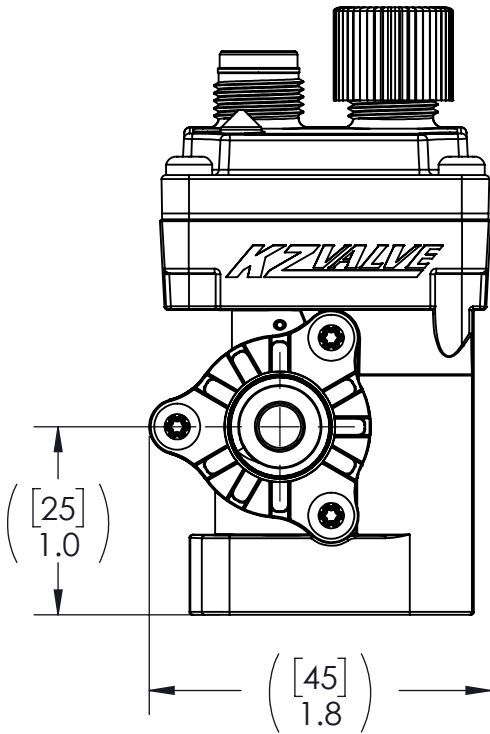
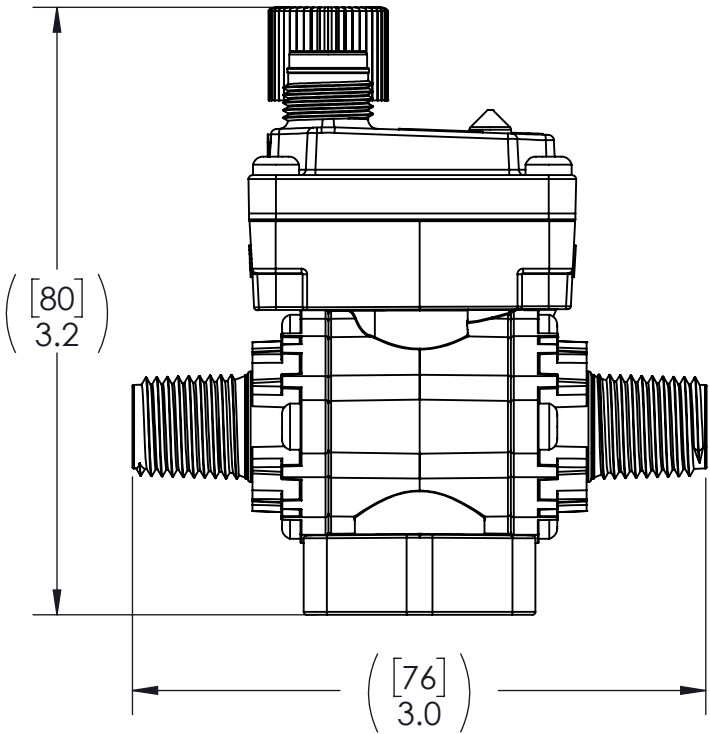
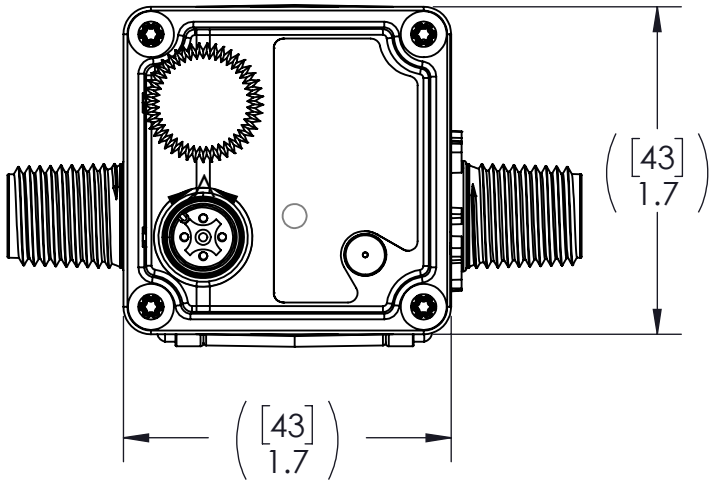

LED INDICATOR STATES			
INDICATOR	RATE	COLOR	STATUS
SOLID	-	GREEN	CURRENTLY AT ON POSITION
SOLID	-	RED	CURRENTLY AT OFF POSITION
BLINKING	2.8 Hz	RED	FAULT/TIMEOUT

CONFORMS TO ASME  
STANDARDS Y14.5-2009

-STANDARD TOLERANCES- -ALL DIMENSIONS IN INCHES [mm]-	
.X±.1 .XX±.01 .XXX±.005 .XX°±1°	TOTAL RUNOUT: .005 FIM CORNER BREAK: .001/.010 SURFACE FINISH: 125 µIN 
DENSITY: 0.047 LBM/CU IN MASS: 0.192 LBM SURF AREA: 89.507 SQ IN VOLUME: 4.095 CU IN	

DESIGNED BY: Daniel Carlson

DRAWN BY: Aaron Goodwin

APPROVED:

SCALE: 1:1

SIZE: B

MATERIAL:  
AS NOTED

**KZVALVE**

23860 K2 PARKWAY  
GREENWOOD, NE 68366 USA  
PHONE: +1.402.944.2767  
FAX: +1.402.944.2402

TITLE: ACTUATED VALVE, EH8, 2 WAY, 1/4" SS BALL,  
1/4" NPT, 0.2S@12/24VDC, SINGLE M12, LED

PART NO: NMZB28-1CEBS-R01

REV: 4

DRAWING NO: NMZB28-1CEBS-R01

SHEET: 1 OF 1