

4

3

2

1

CONFIDENTIAL AND PROPRIETARY TO KZCO, INC. UNAUTHORIZED USE, DISCLOSURE OF REPRODUCTION IS PROHIBITED

FOR MORE DETAILS AND INFORMATION, CONTACT: SALES@KZCO.COM

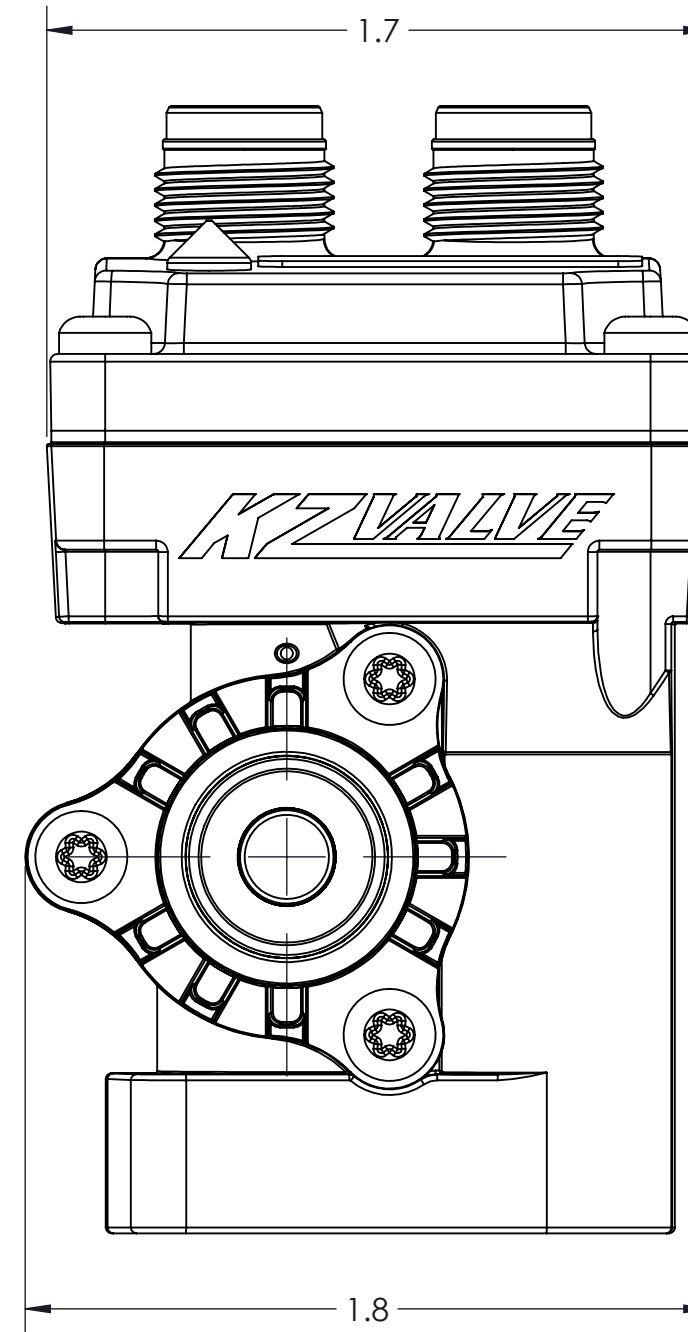
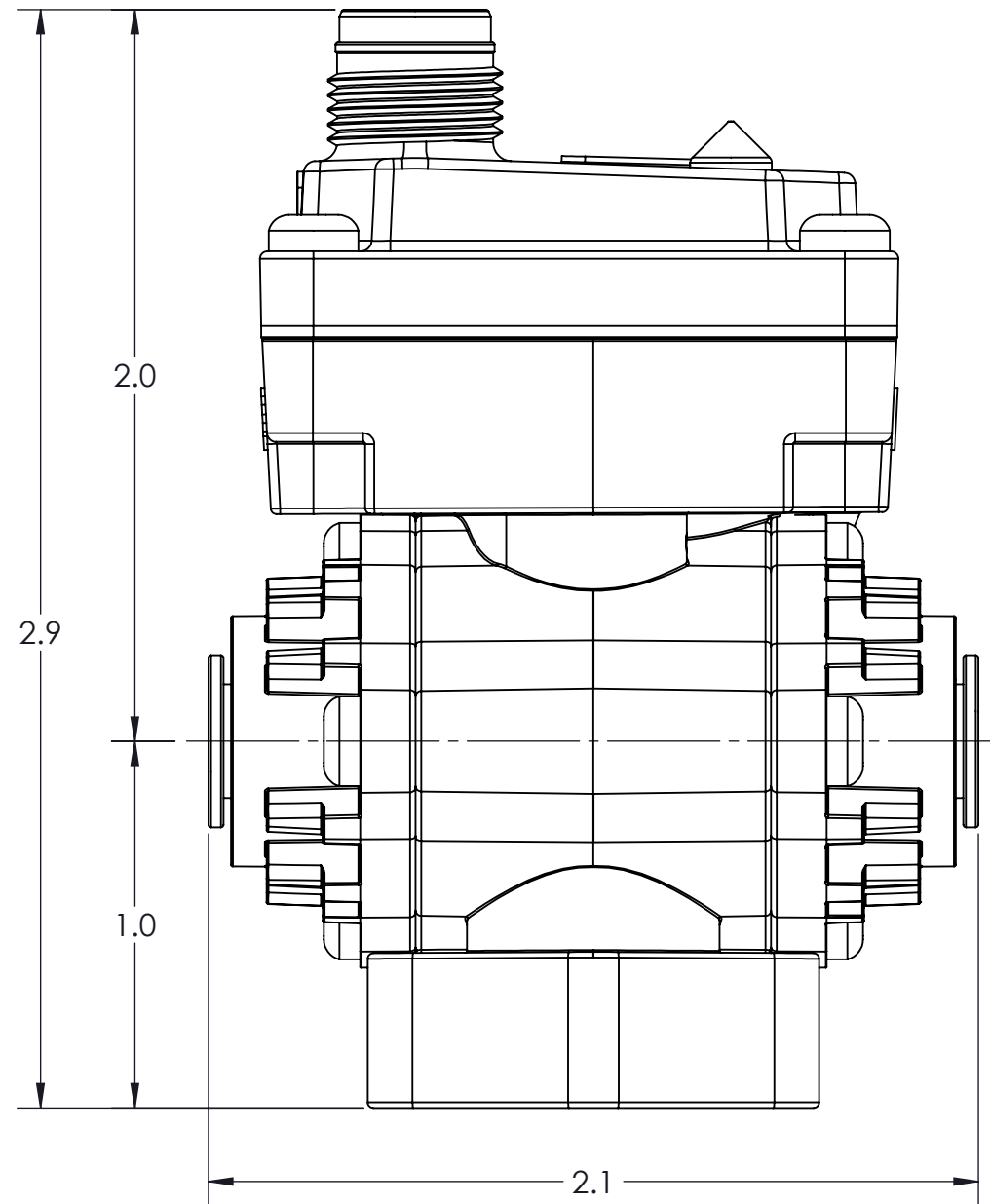

CONFORMS TO ASME STANDARDS Y14.5-2009

-STANDARD TOLERANCES- -ALL DIMENSIONS IN INCHES [mm]-	
.X±0.1	TOTAL RUNOUT: .005 FIM CORNER BREAK: .001/.010 SURFACE FINISH: 125 µIN
.XX±0.01	
.XXX±0.005	
.X°±1°	
DENSITY: 0.072 LBM/CU IN MASS: 0.276 LBM SURF AREA: 85.108 SQ IN VOLUME: 3.862 CU IN	

DESIGNED BY: Inna Zevakina
DRAWN BY: Aaron Goodwin
APPROVED:
SCALE: 2:1
SIZE: B
MATERIAL: AS NOTED

		23860 KZ PARKWAY GREENWOOD, NE 68366 USA PHONE: +1.402.944.2767 FAX: +1.402.944.2402	
		TITLE: ACTUATED VALVE, EH8, 2 WAY, M12, 1/4" SS BALL, 1/4" PTC, 0.2S@12VDC, LEDS	
PART NO: NNZB28-10DA0-Q01	REV: 1		
DRAWING NO: SALES_NNZB28-10DA0-Q01	SHEET: 1 OF 1		

4

3

2

1

B

B

A

A