

4

3

2

1

CONFIDENTIAL AND PROPRIETARY TO KZCO, INC. UNAUTHORIZED USE, DISCLOSURE OF REPRODUCTION IS PROHIBITED

FOR MORE DETAILS AND INFORMATION, CONTACT: SALES@KZCO.COM

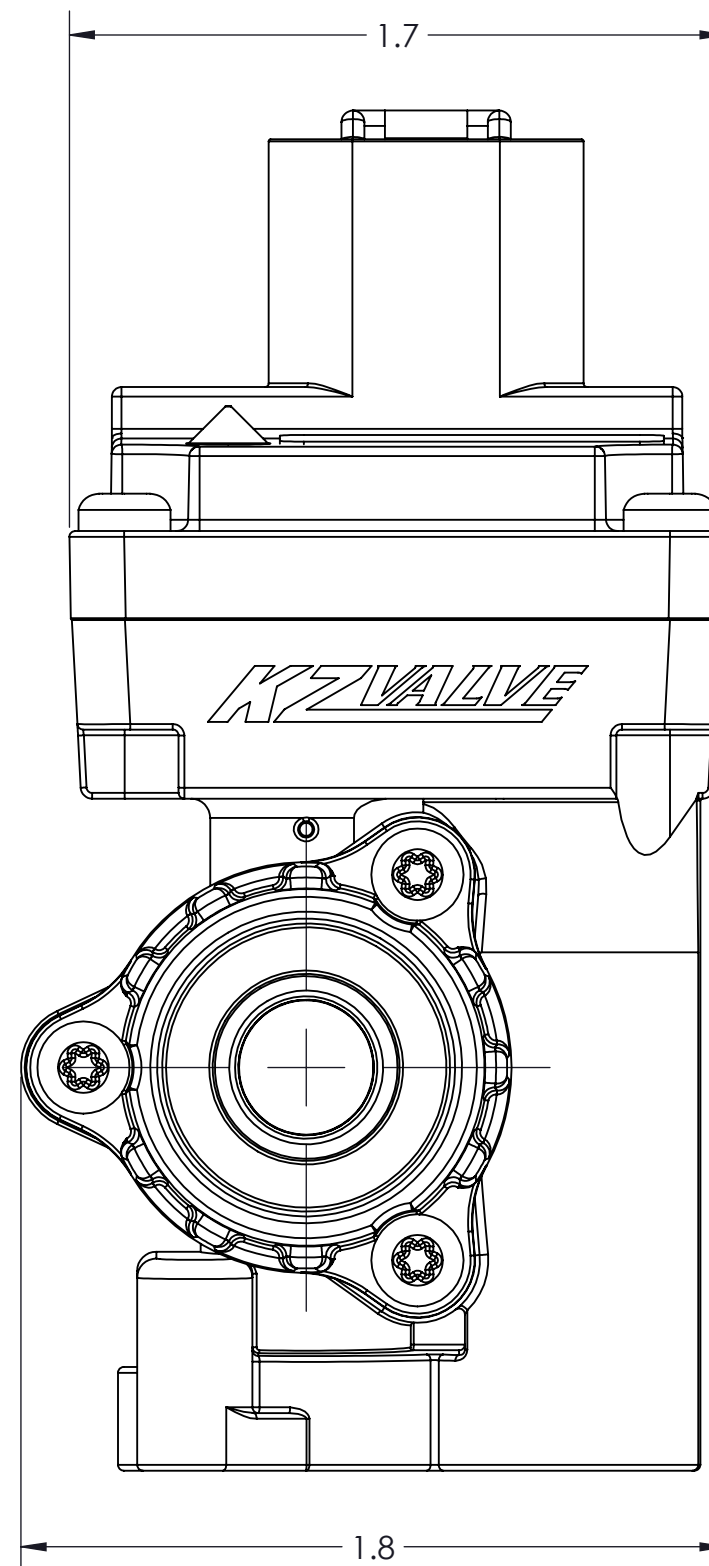
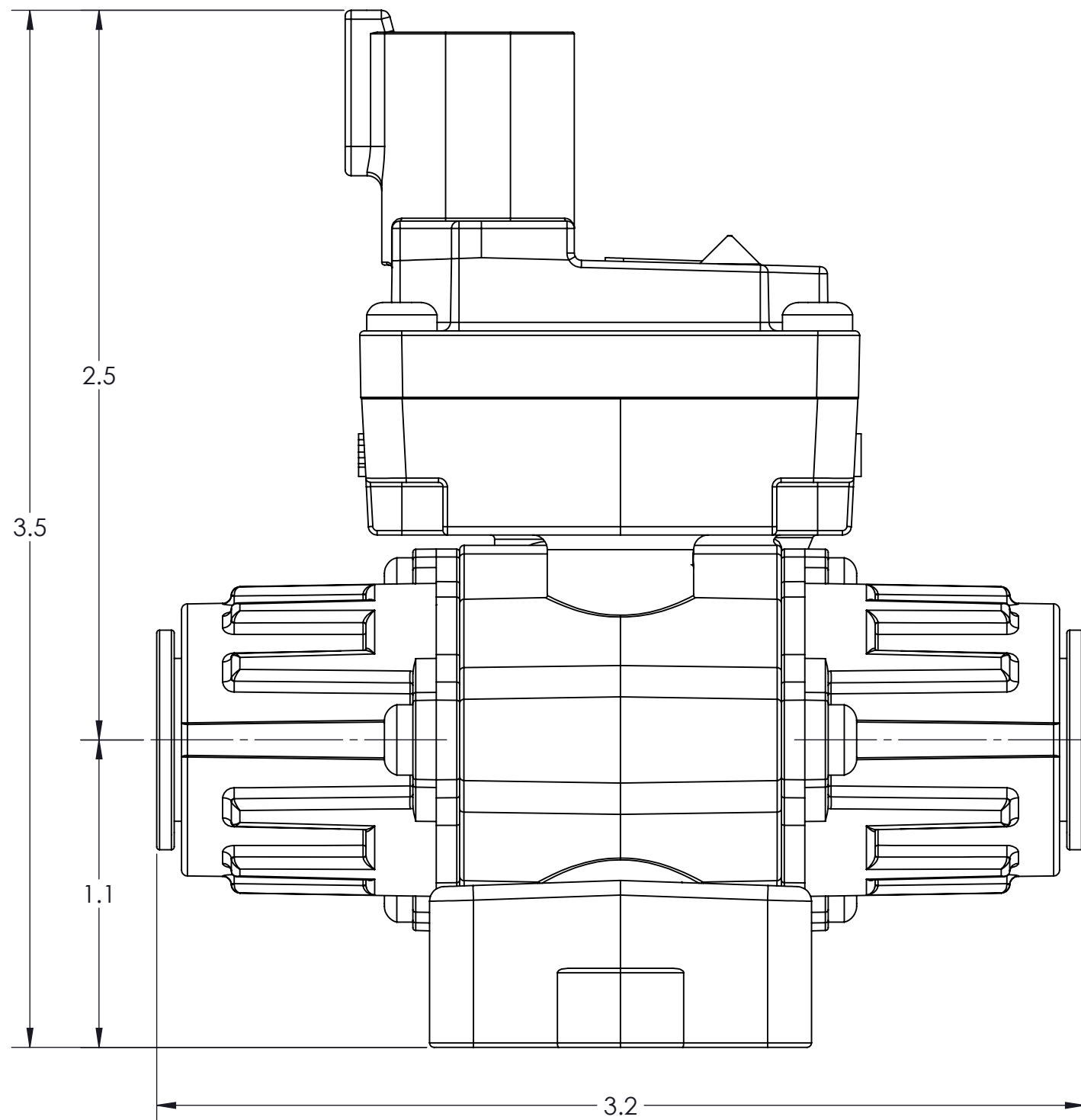

-STANDARD TOLERANCES- -ALL DIMENSIONS IN INCHES [mm]-	
.X±0.1	TOTAL RUNOUT: .005 FIM CORNER BREAK: .001/.010 SURFACE FINISH: 125 µIN
.XX±0.01	
.XXX±0.005	
.X°±1°	
DENSITY: 0.082 LBM/CU IN MASS: 0.383 LBM SURF AREA: 100.948 SQ IN VOLUME: 4.656 CU IN	

CONFORMS TO ASME STANDARDS Y14.5-2009

DESIGNED BY: Evan Schwahn
 DRAWN BY: Aaron Goodwin
 APPROVED:
 SCALE: 2:1
 SIZE: B
 MATERIAL: AS NOTED



23860 KZ PARKWAY
 GREENWOOD, NE 68366 USA
 PHONE: +1.402.944.2767
 FAX: +1.402.944.2402

TITLE: ACTUATED VALVE, EH8 2-WAY, 3/8" SS BALL,
 1/2" PTC, 0.2S@12VDC, DEUTSCH LED

PART NO: NQZC28-10DA0-D01	REV: 1
DRAWING NO: SALES_NQZC28-10DA0-D01	SHEET: 1 OF 2

4

3

2

1

B

B

A

A