

4

3

2

1

CONFIDENTIAL AND PROPRIETARY TO
KZCO, INC. UNAUTHORIZED USE, DISCLOSURE
OF REPRODUCTION IS PROHIBITED

FOR MORE DETAILS AND INFORMATION, CONTACT: SALES@KZCO.COM

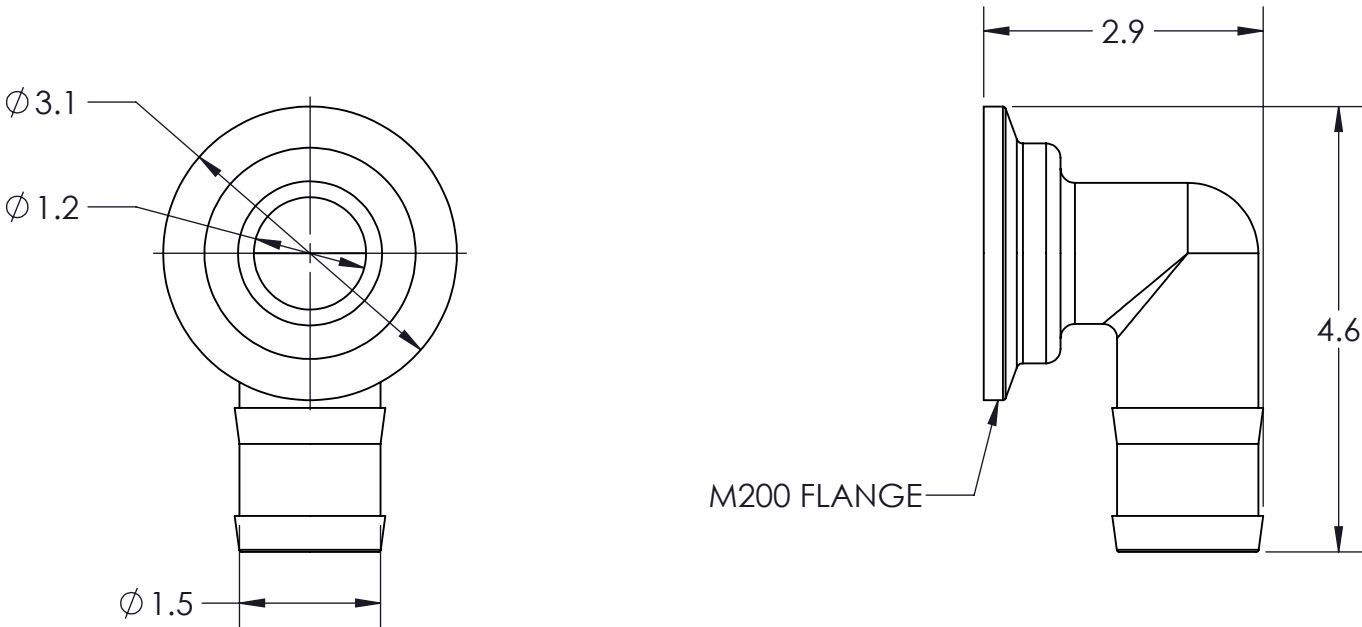

CONFORMS TO ASME
STANDARDS Y14.5-2009

-STANDARD TOLERANCES- -ALL DIMENSIONS IN INCHES [mm]-		DESIGNED BY: Larry Erdkamp		<div><div>23860 KZ PARKWAY GREENWOOD, NE 68366 USA PHONE: +1.402.944.2767 FAX: +1.402.944.2402</div></div>		
.X±0.1	TOTAL RUNOUT: .005 FIM CORNER BREAK: .001/.010 SURFACE FINISH: 125 µIN 	DRAWN BY: Tanner Buresh				
.XX±0.001		APPROVED:				
.XXX±0.005		SCALE: 1:2				
.XX°±1°		SIZE: B		PART NO: QX-183	REV: 1	
DENSITY: 0.032 LBM/CU IN MASS: 0.183 LBM SURF AREA: 56.637 SQ IN VOLUME: 5.725 CU IN		MATERIAL: POLYPROPYLENE		DRAWING NO: SALES_QX-183	SHEET: 1 OF 1	