

4

3

2

1

CONFIDENTIAL AND PROPRIETARY TO KZCO, INC. UNAUTHORIZED USE, DISCLOSURE OF REPRODUCTION IS PROHIBITED

FOR MORE DETAILS AND INFORMATION, CONTACT: SALES@KZCO.COM

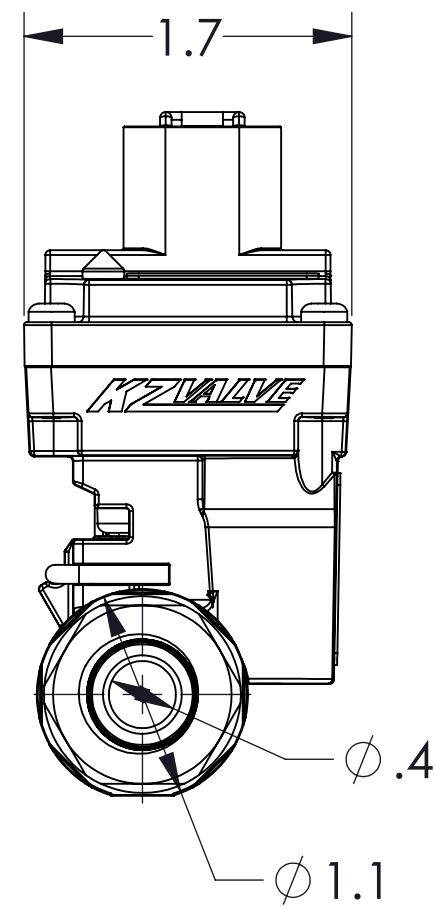
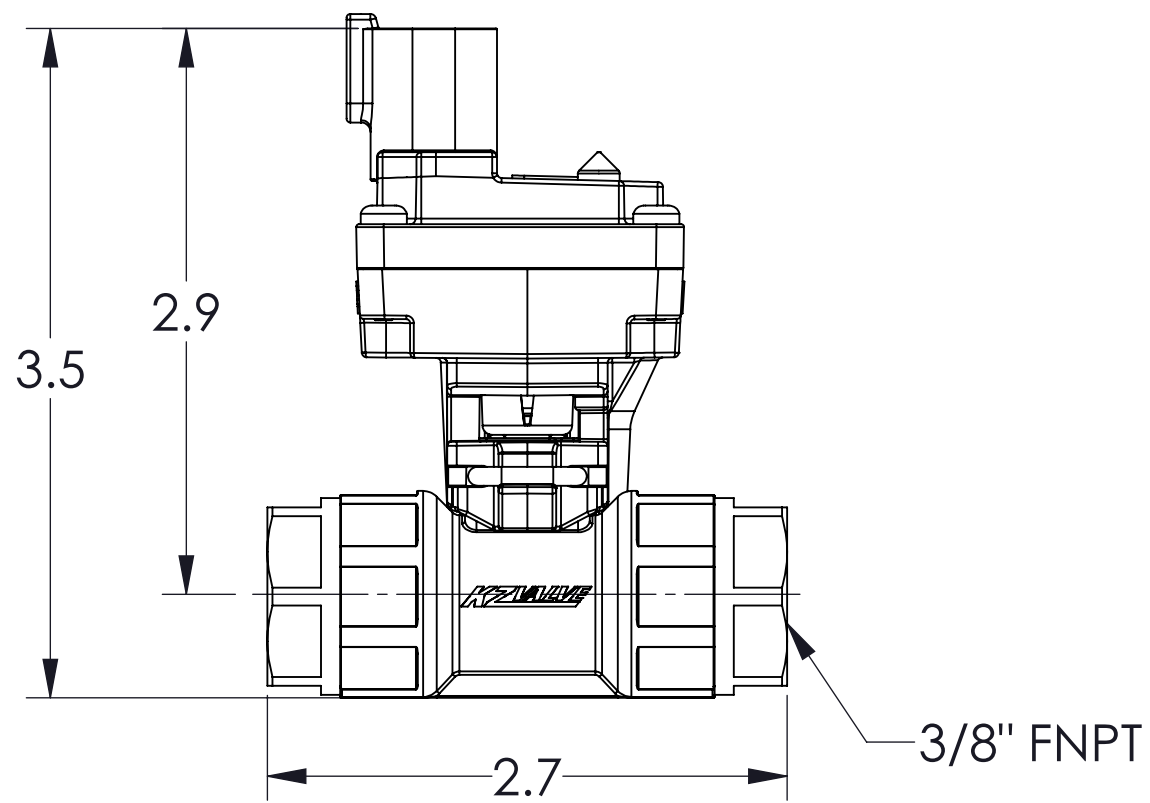

CONFORMS TO ASME STANDARDS Y14.5-2009

-STANDARD TOLERANCES- -ALL DIMENSIONS IN INCHES [mm]- .X±0.1 .XX±0.001 .XXX±0.005 .X°±1°	TOTAL RUNOUT: .005 FIM CORNER BREAK: .001/.010 SURFACE FINISH: 125 μIN 	DESIGNED BY: Tanner Buresh		23860 KZ PARKWAY GREENWOOD, NE 68366 USA PHONE: +1.402.944.2767 FAX: +1.402.944.2402
		DRAWN BY: Tanner Buresh		
DENSITY: 0.136 LBM/CU IN MASS: 0.555 LBM SURF AREA: 90.975 SQ IN VOLUME: 4.078 CU IN		APPROVED:	PART NO: S8C28-1CDB0-D01	REV: 1
		SCALE: 1:1	DRAWING NO: SALES_S8C28-1CDB0-D01	SHEET: 1 OF 1
		SIZE: B		
		MATERIAL: AS NOTED		

4

3

2

1

A

A

B

B