

DESIGN NOTES:

- PART NUMBER: TSL-SLV25
- EXPOSED MATERIALS: NYLON, POLYESTER FILM, GORTEX, GF PP
- CONTROL TYPE(s): 3 MODES
 - ON/OFF
 - SCROLLING (POSITIONABLE)
 - PRESET (USER POSITIONED)
- CONNECTIONS:
 - CONTROLLER PINOUT
 - PIN 1: BLANK
 - PIN 2: BLANK
 - PIN 3: BLANK
 - PIN 4: BLANK
 - PIN 5: BLANK
 - PIN 6: BLANK
 - PIN 7: BLANK
 - PIN 8: BLANK
 - PIN 9 (VIOLET): SIG 2 (+) TO CLOSE
 - PIN 10 (ORANGE): SIG 1 (+) TO OPEN
 - PIN 11 (BLACK): POWER IN (-) TO CONTROLLER
 - PIN 12 (RED): POWER IN (+) TO CONTROLLER
 - PINOUT TO MASTER
 - PIN 9 (ORANGE): SIG 2 (+) TO CLOSE
 - PIN 10 (VIOLET): SIG 1 (+) TO OPEN
- COMPATIBLE CONTROLLER:
 - TSL MASTER CONTROLLER

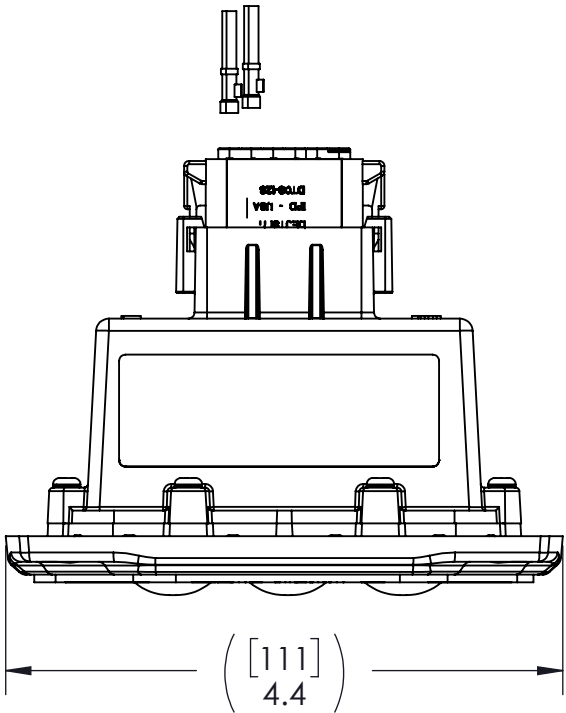

CUSTOMER REVISIONS			
REV	ECN	CHANGE	MODIFIED BY
1	25-0013	CREATED CUSTOMER SHEET	Austin Gemar

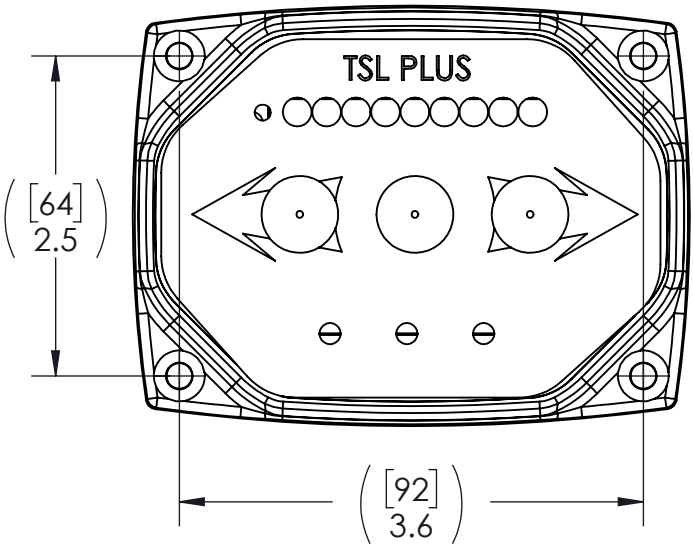
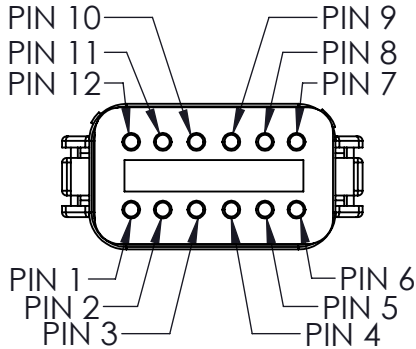
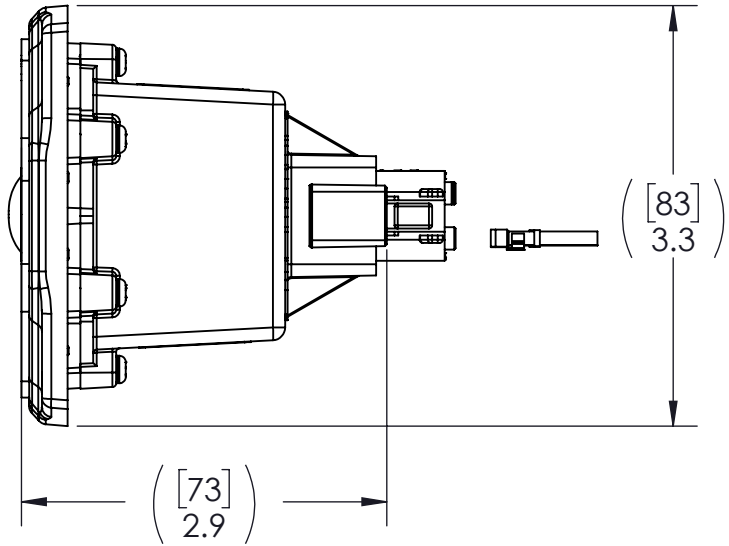

IMAGE OF MEMBRANE

MANUAL AVAILABLE UNDER PART NUMBER 509-0004

CONFORMS TO ASME
STANDARDS Y14.5-2009
DENSITY: 0.538 LBM/CU IN
MASS: 5.688 LBM
SURF AREA: 453.500 SQ IN
VOLUME: 10.581 CU IN

DESIGNED BY: Austin Gemar
DRAWN BY: Austin Gemar
APPROVED:
SCALE: 1:2
SIZE: B
MATERIAL: AS NOTED

KZVALVE
TITLE: CONTROLLER ASSY, SC, SLAVE, 25
PART NO: TSL-SLV25
DRAWING NO: TSL-SLV25

23860 KZ PARKWAY
GREENWOOD, NE 68366 USA
PHONE: +1.402.944.2767
FAX: +1.402.944.2402
REV: 2
SHEET: 2 OF 2